

MAJOR ENTRY MONUMENTATION - FIGURE IV-19

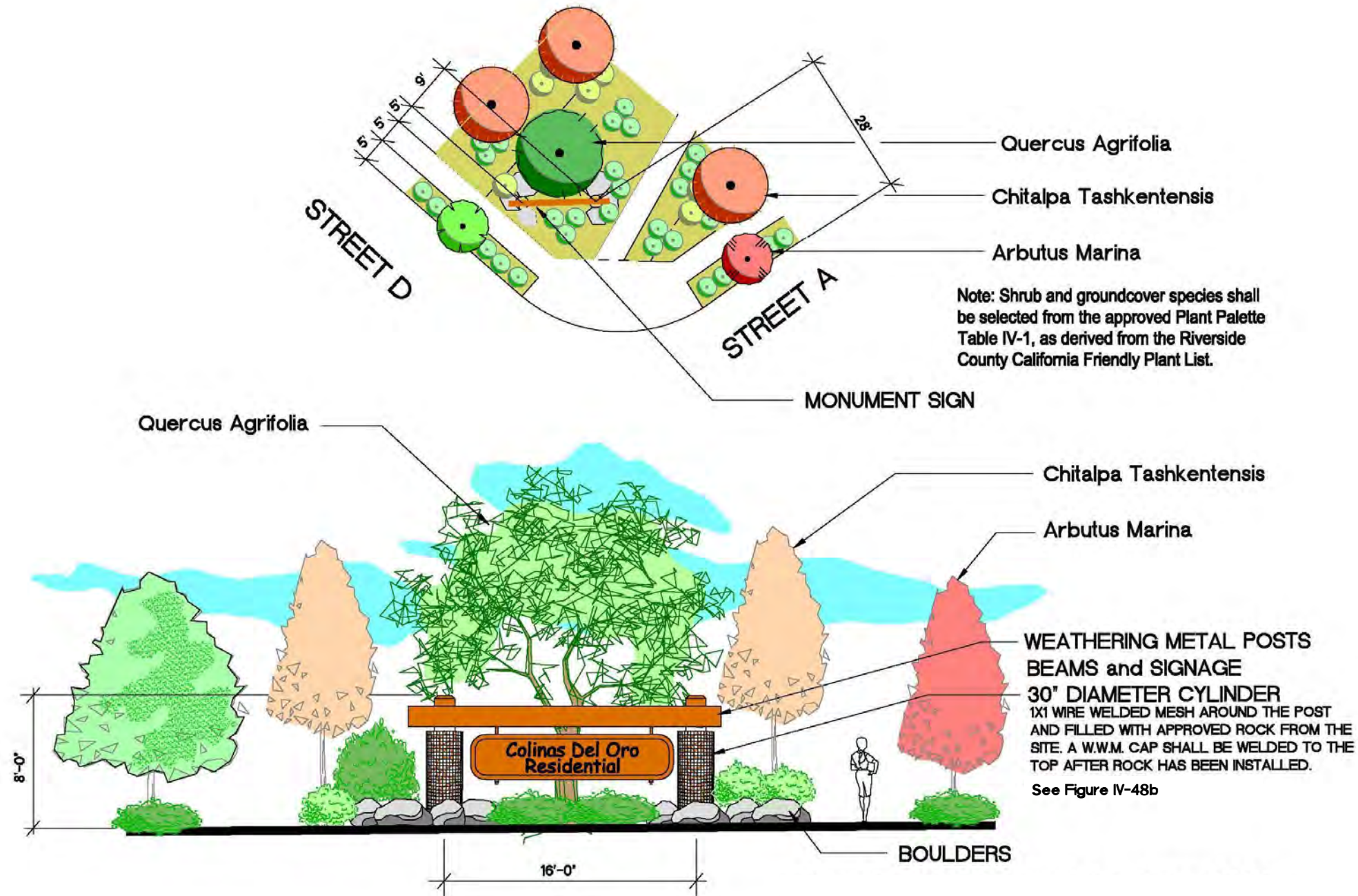

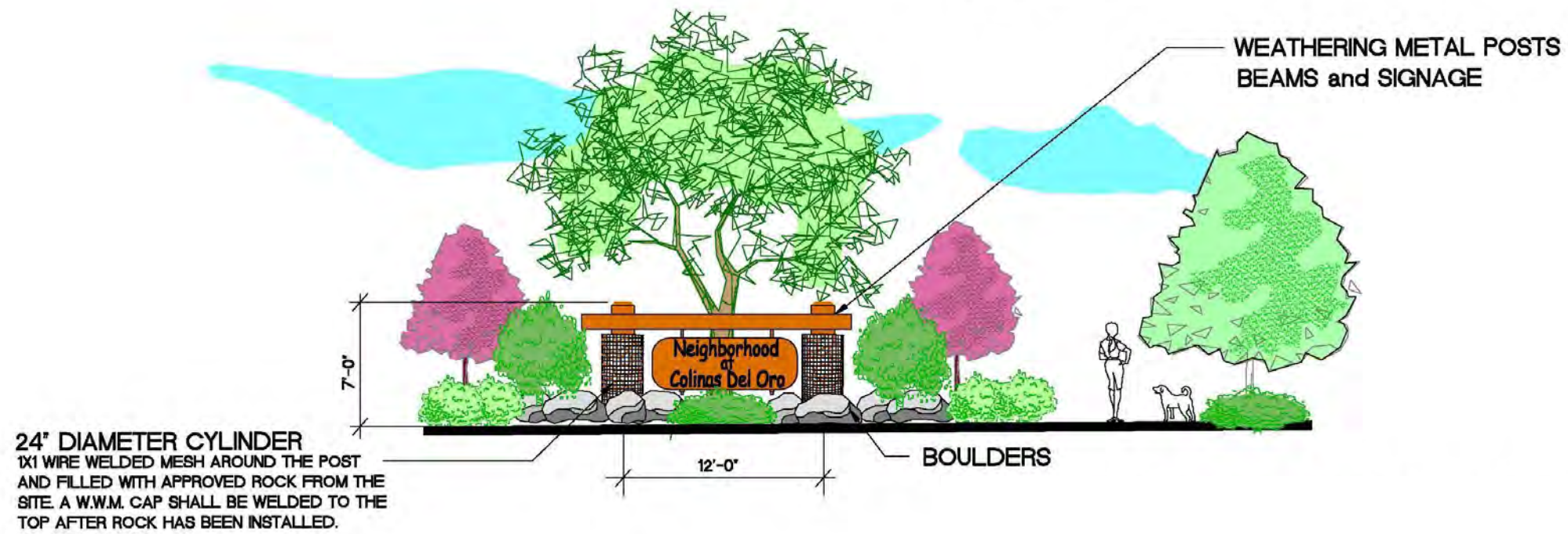

See Figure IV-48b

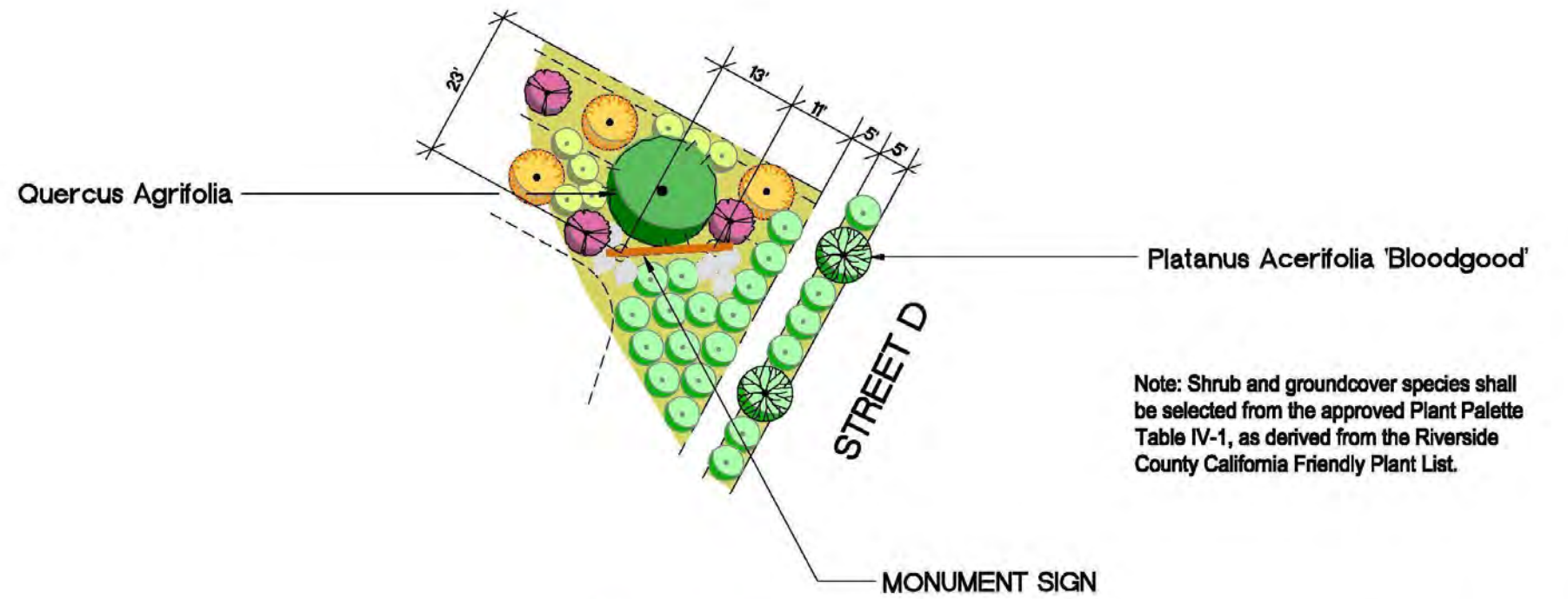

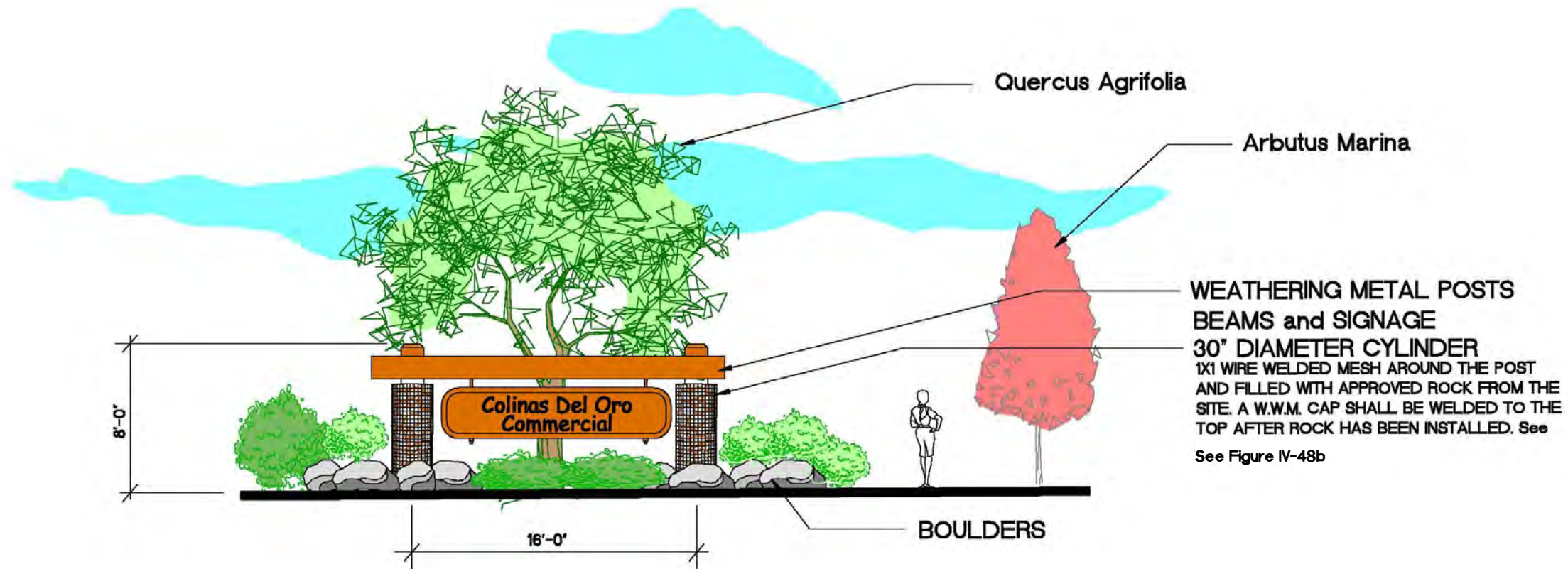
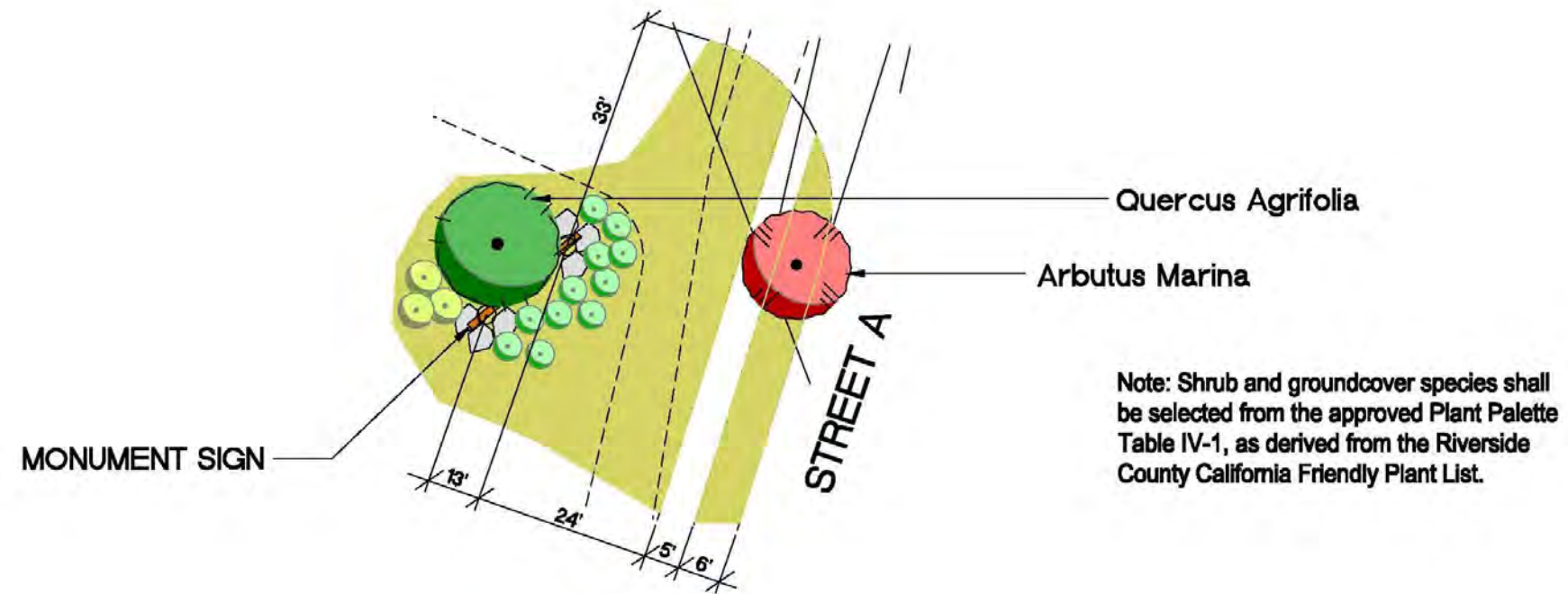

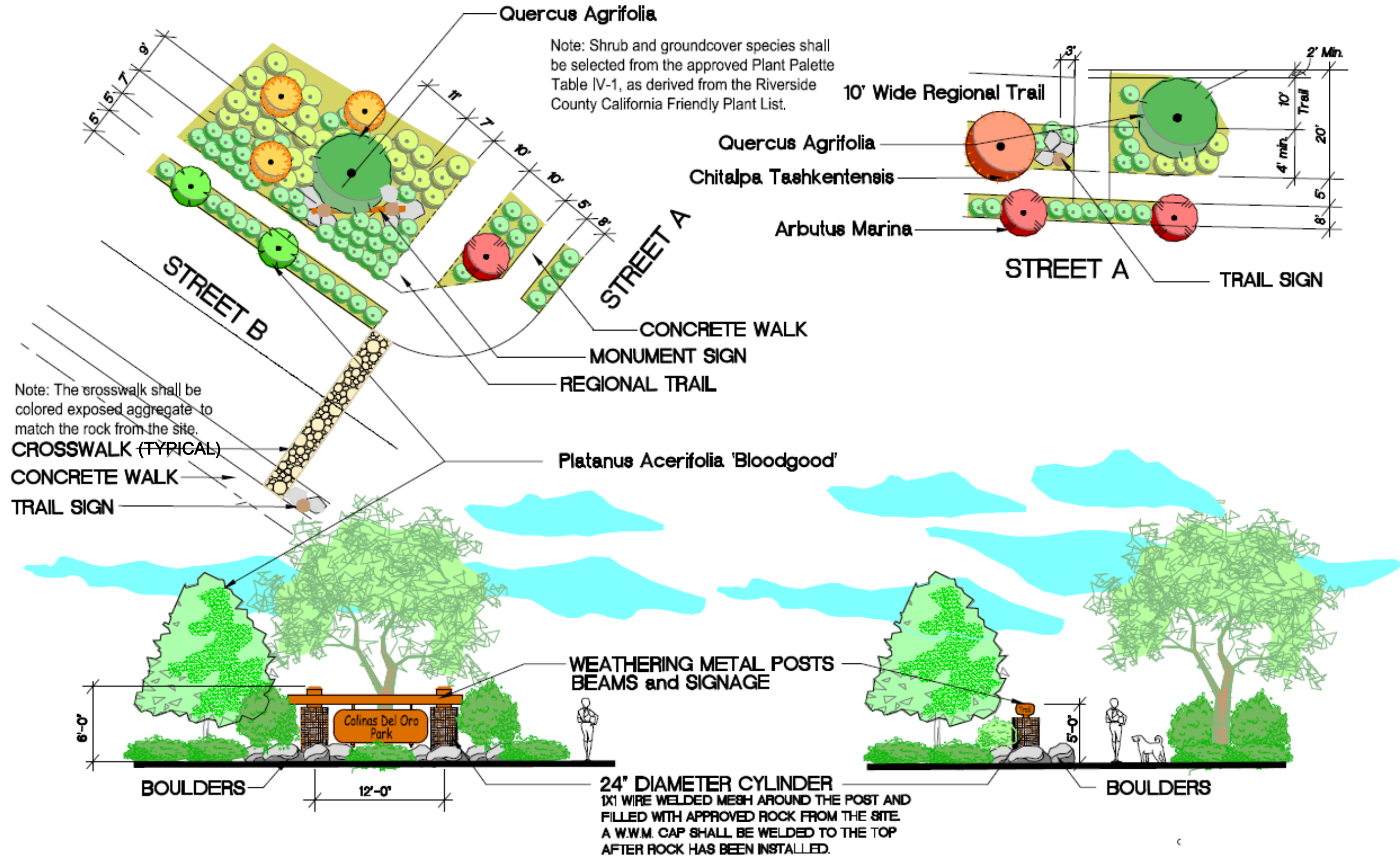

See Figure IV-48b

PARK AND TRAIL MONUMENTATION - FIGURE IV-23



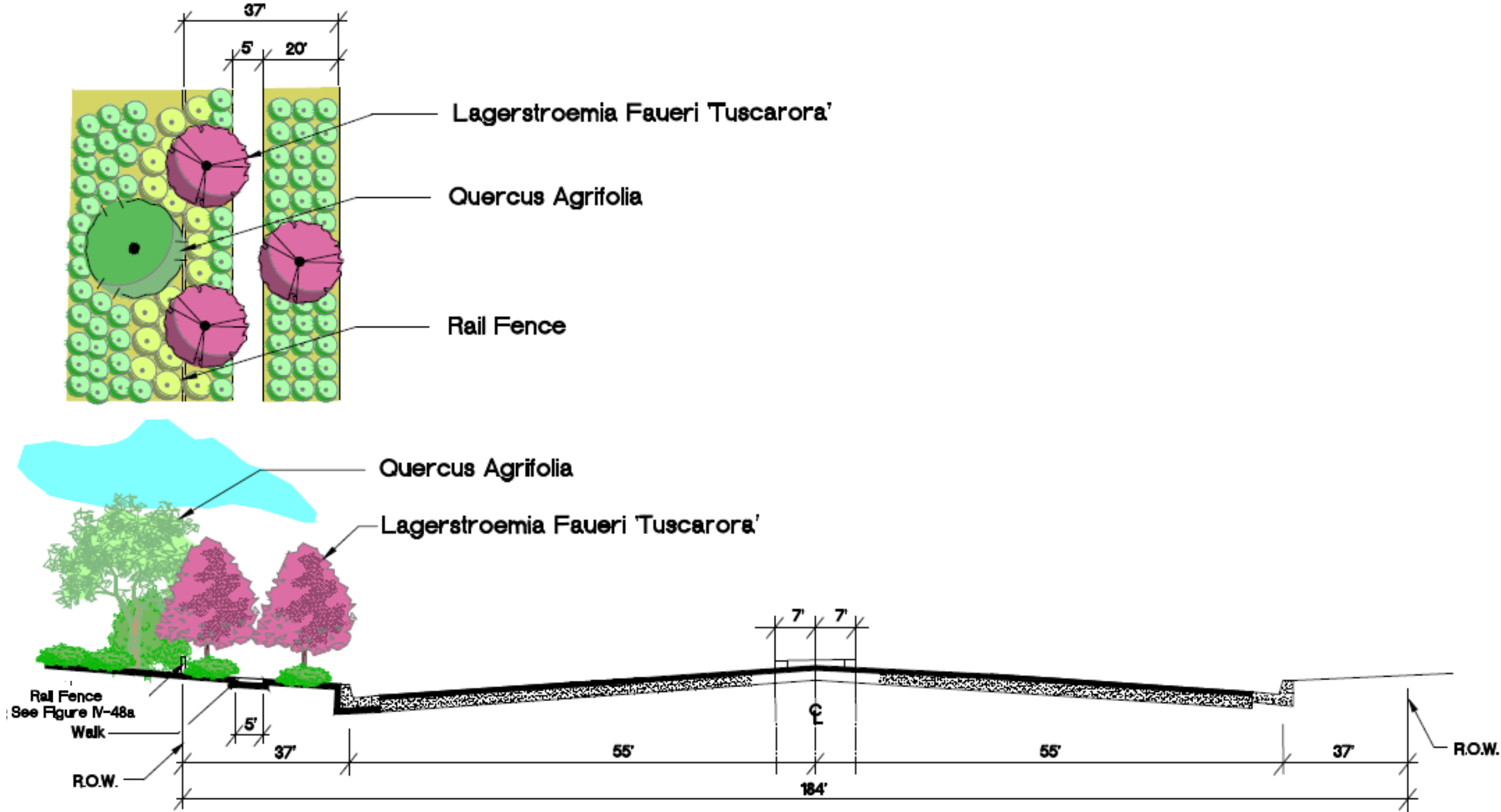

Note: Shrub and groundcover species shall be selected from the approved Plant Palette Table IV-1, as derived from the Riverside County California Friendly Plant List.

Note: All planting for SR 74 shall conform to Caltrans Planting Requirements.



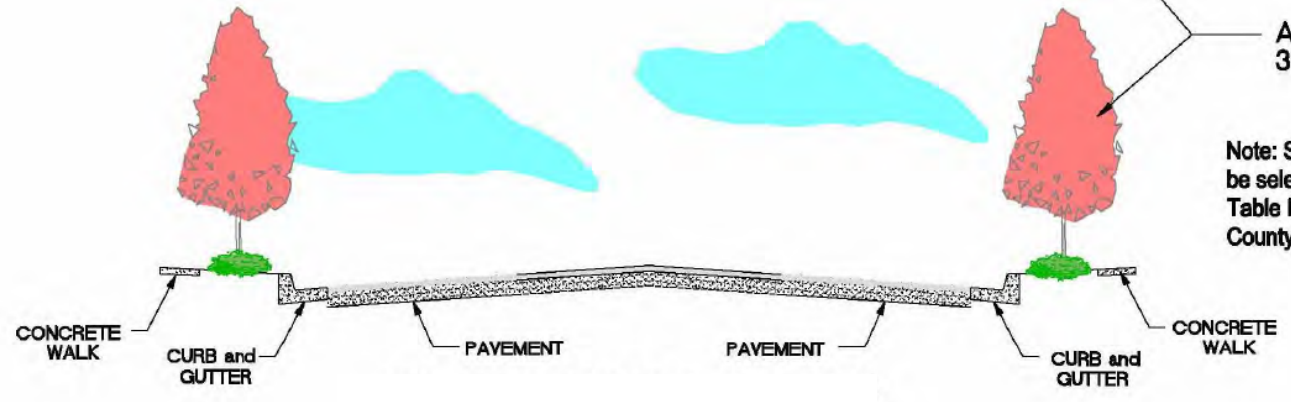
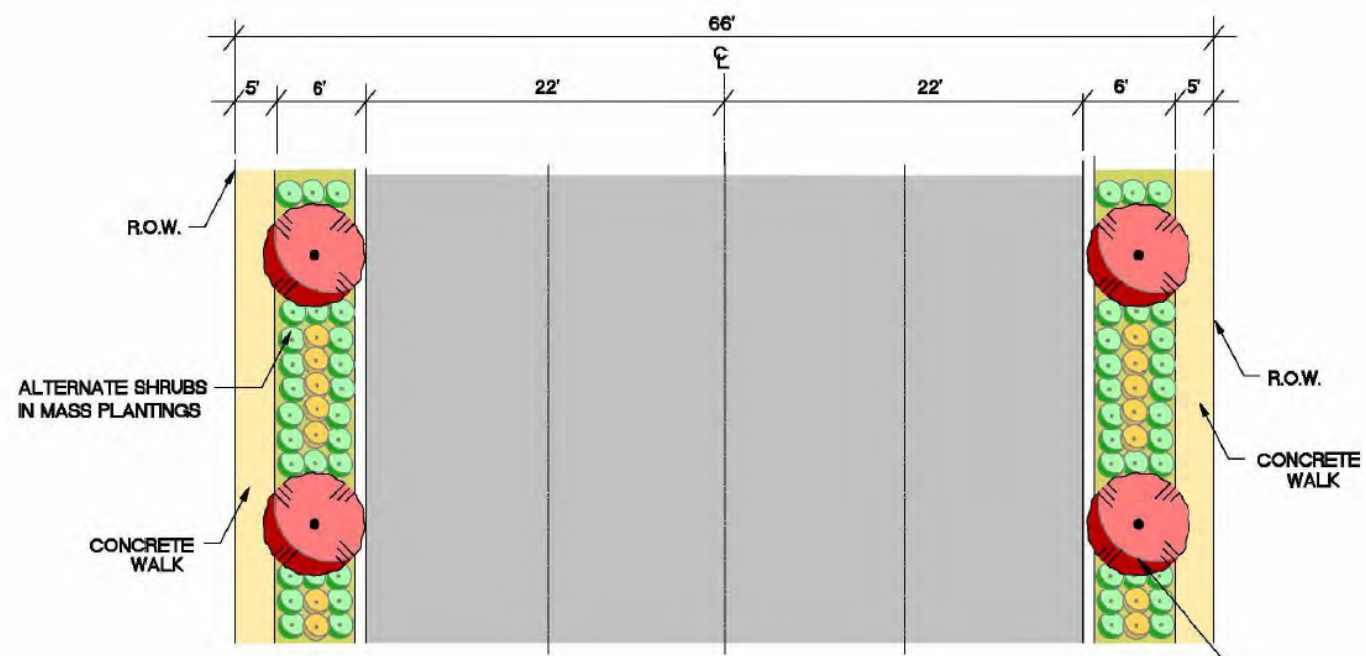

STREET "A" (NORTH OF "D")

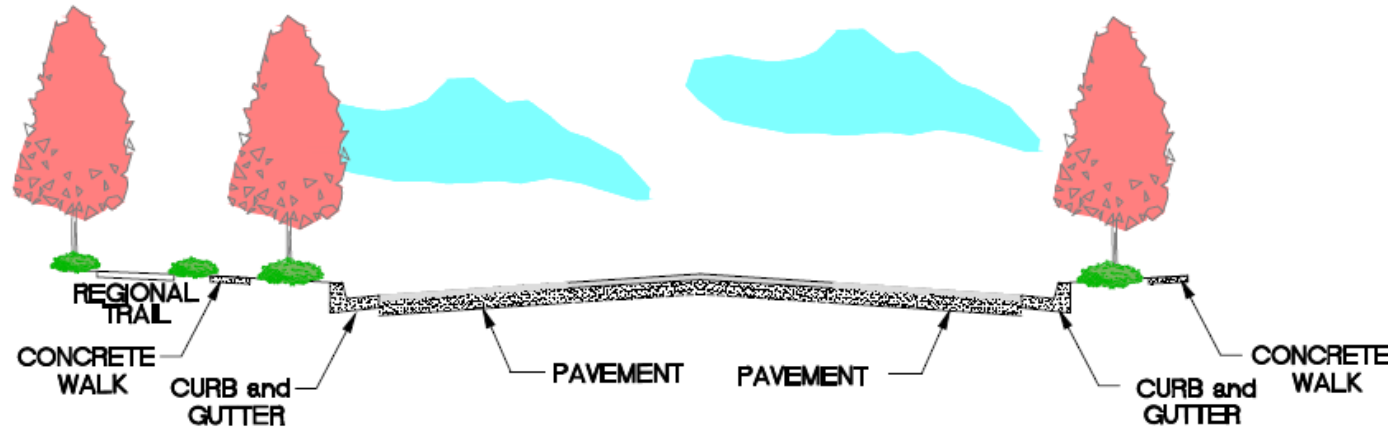
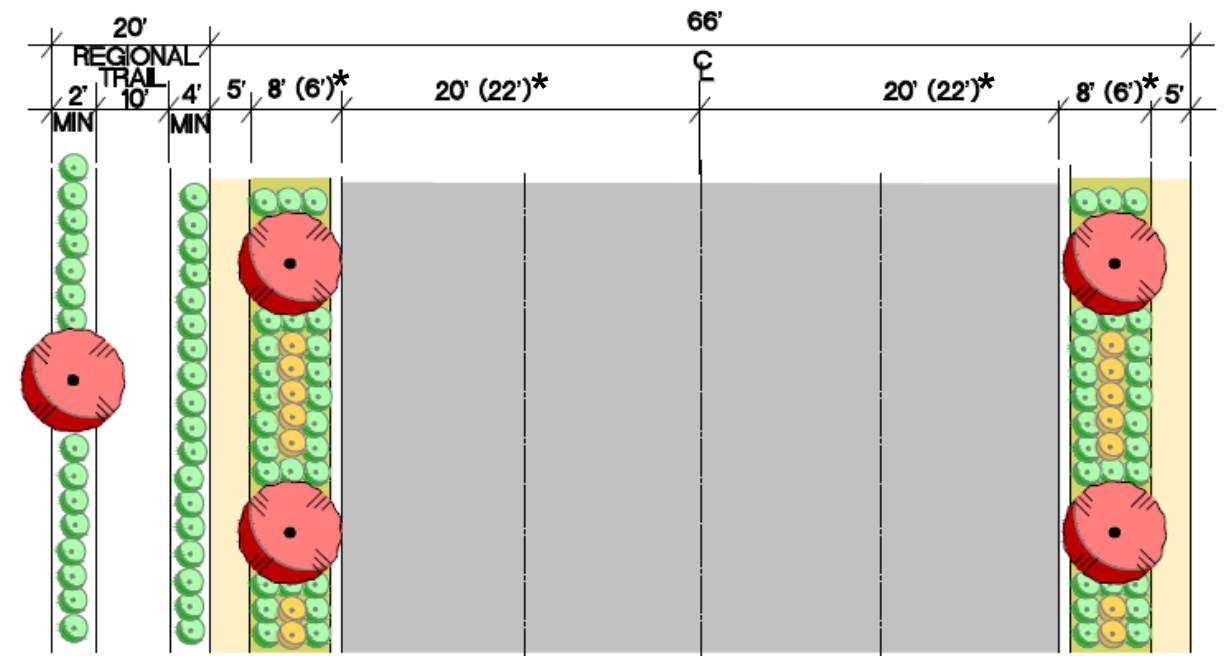

STREET "A" (BETWEEN "D" AND "B"), AND STREET "B" (BETWEEN "A" AND HWY 74)
* DENOTES STREET "B" (BETWEEN "A" AND HWY 74)

STREET "A" (NORTH OF STREET "D"), STREET "A" (BETWEEN STREETS "D" AND "B"), AND STREET "B" (BETWEEN STREET "A" AND SR 74) – ENHANCED LOCAL STREET (66' ROW) STREETScape- FIGURE IV-25



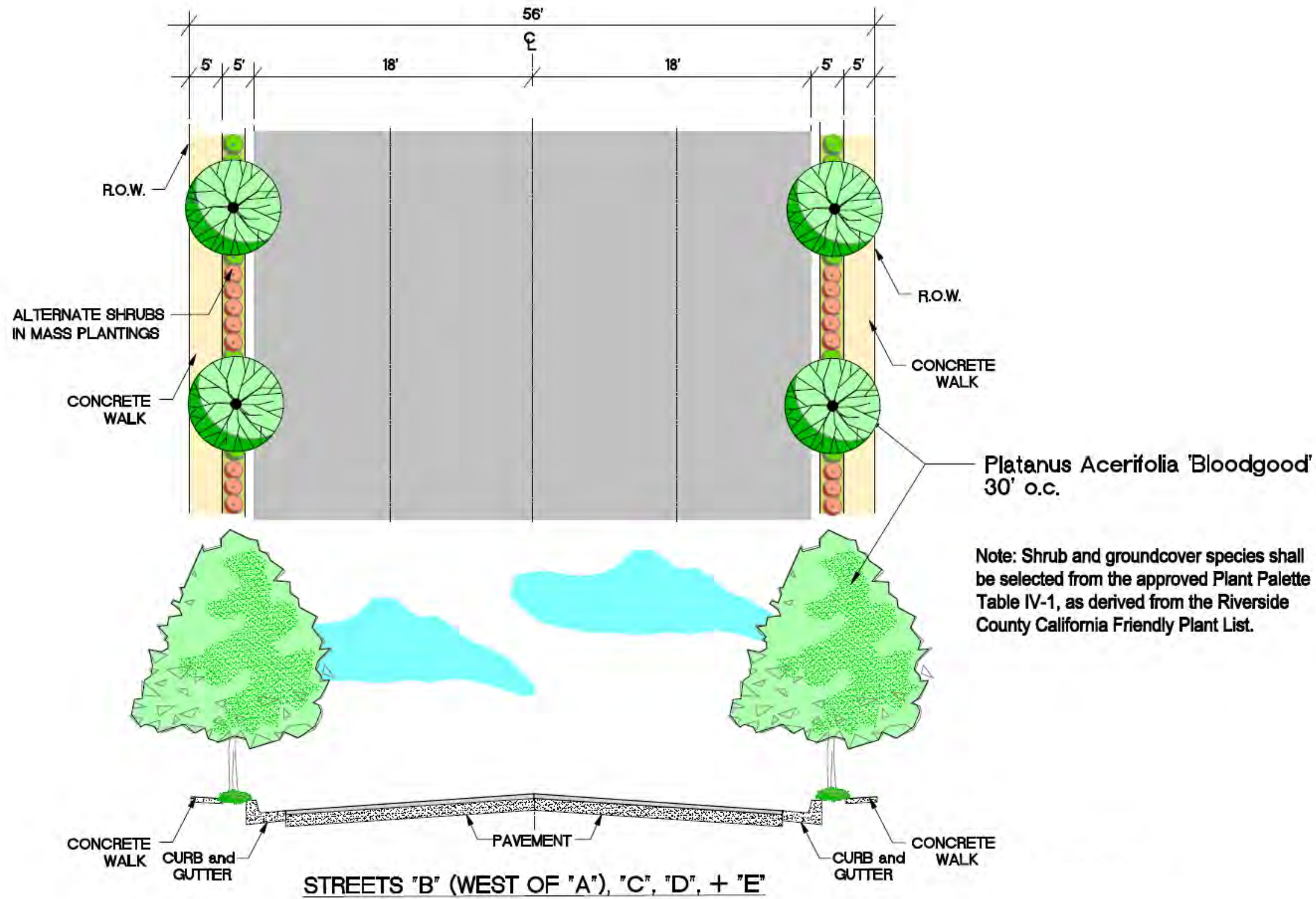

STREETS "B" (WEST OF STREET "A"), "C", "D", AND "E" - LOCAL STREET (56' ROW) STREETScape - FIGURE IV-26

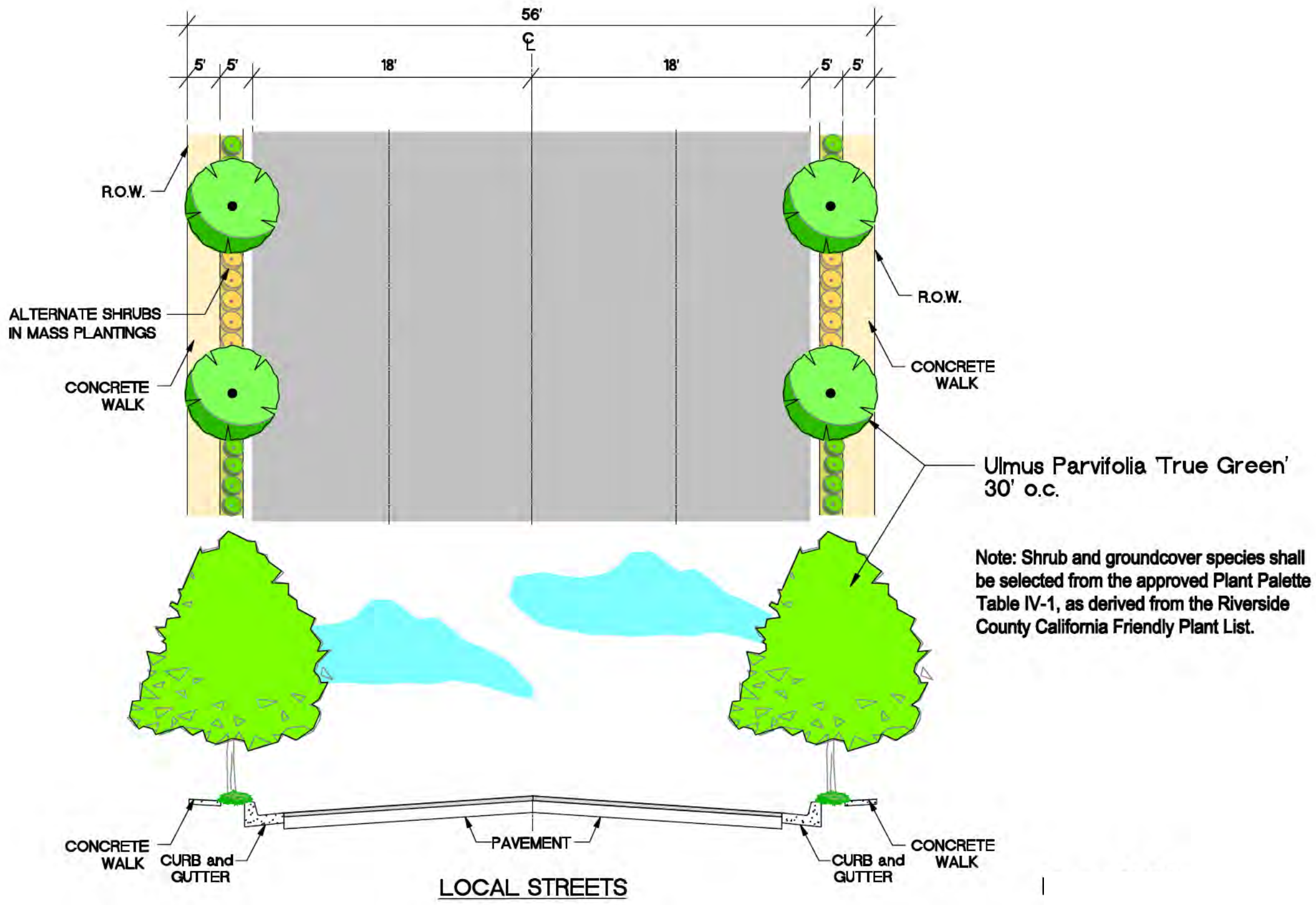

LOCAL STREET - 56' ROW STREETSCAPE - FIGURE IV-27



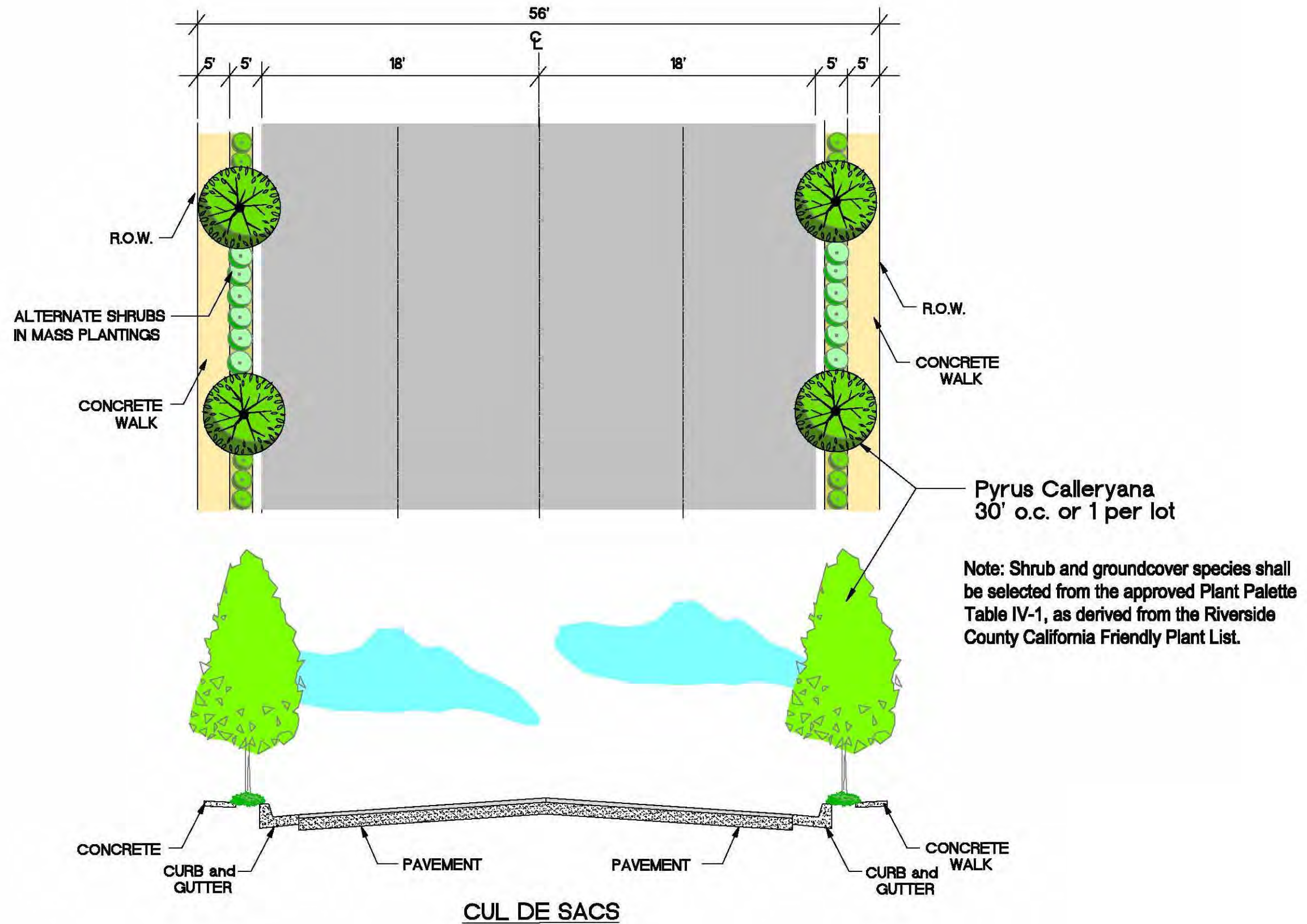

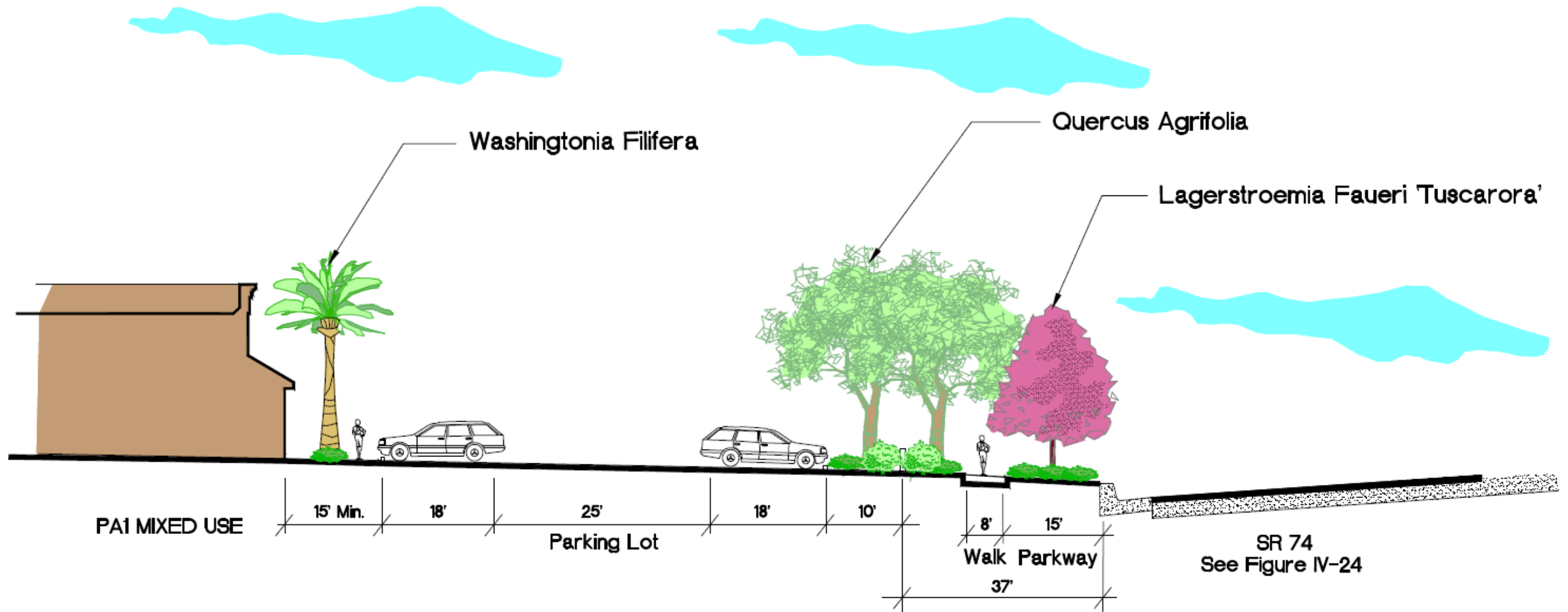

Pad forward design shall be utilized when feasible.

Note: Shrub and groundcover species shall be selected from the approved Plant Palette Table IV-1, as derived from the Riverside County California Friendly Plant List.

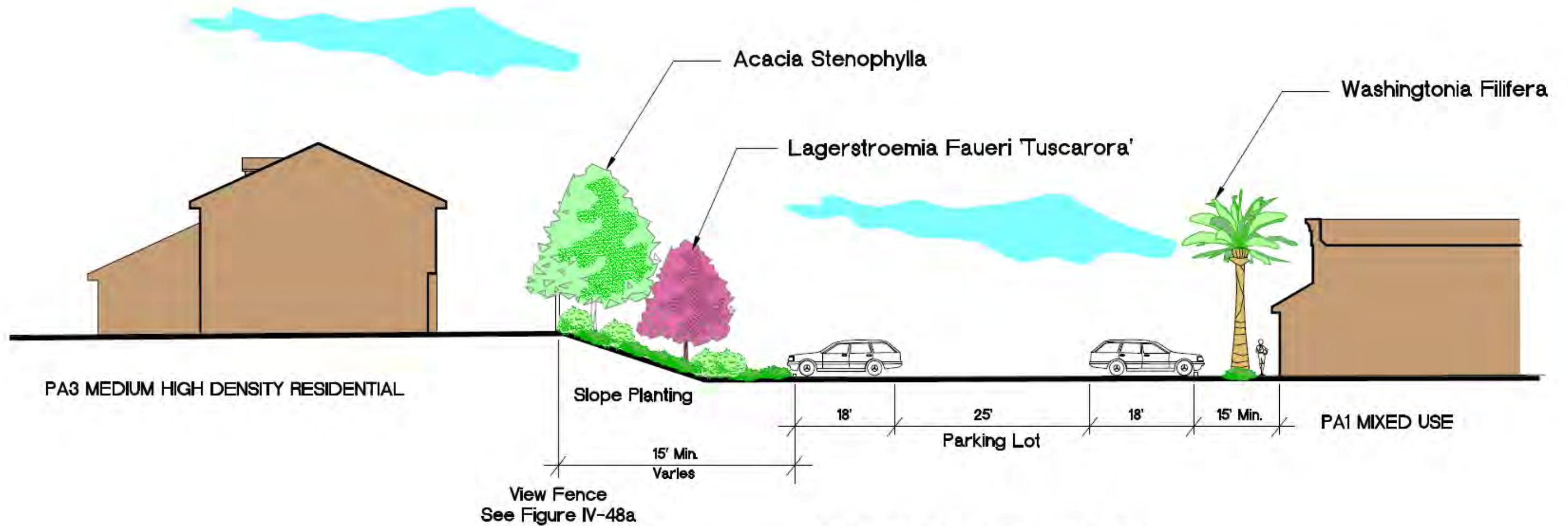

Note: Shrub and groundcover species shall be selected from the approved Plant Palette Table IV-1, as derived from the Riverside County California Friendly Plant List.

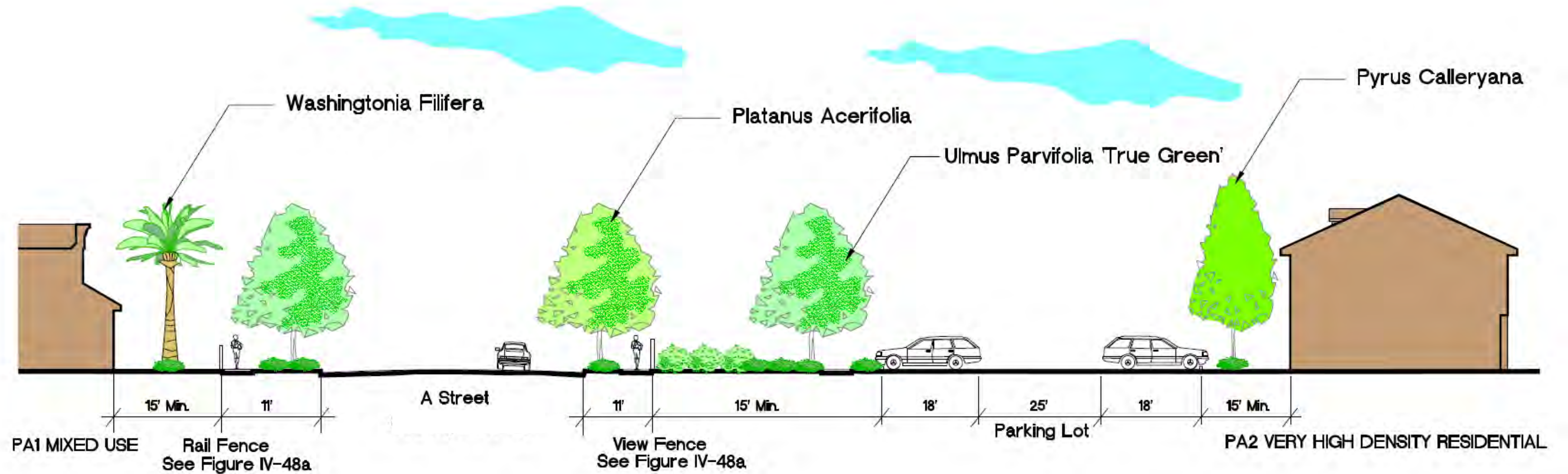

Note: Shrub and groundcover species shall be selected from the approved Plant Palette Table IV-1, as derived from the Riverside County California Friendly Plant List.

PA1 MIXED USE - PA2 VERY HIGH DENSITY RESIDENTIAL EDGE CONDITION - FIGURE IV-31

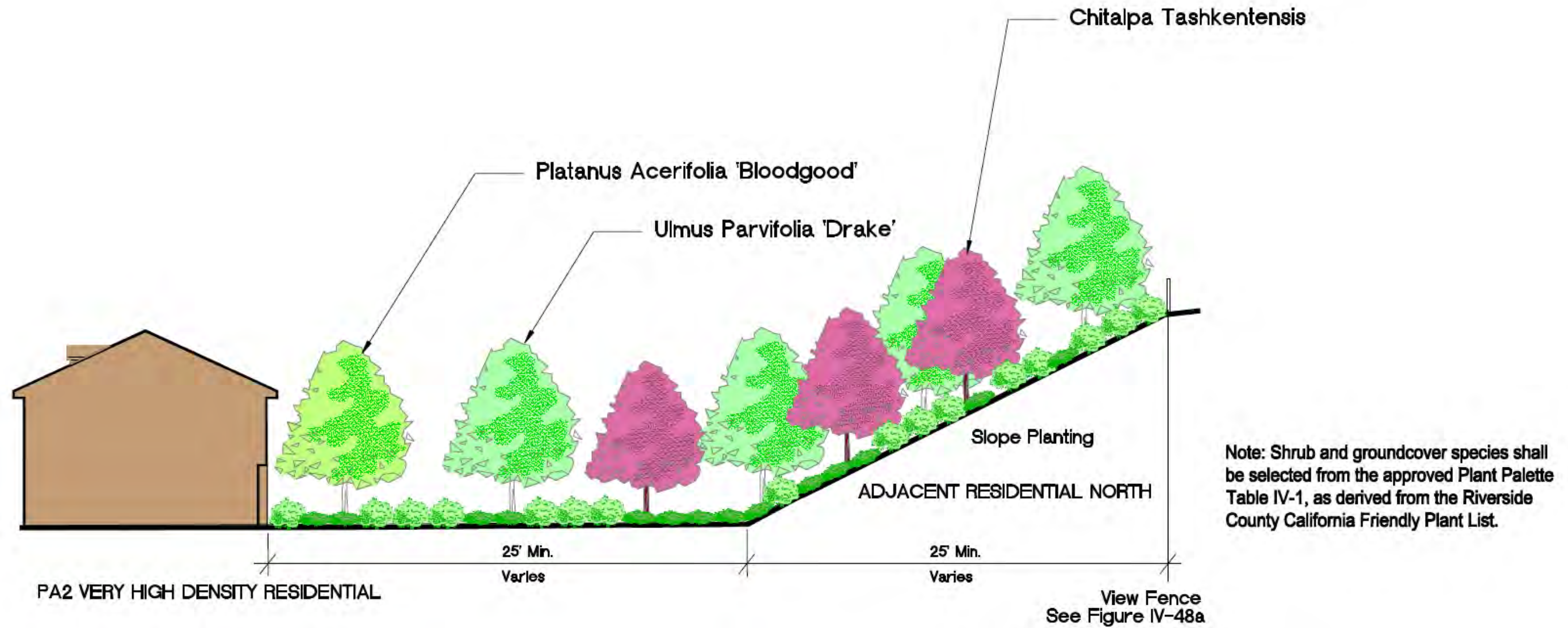

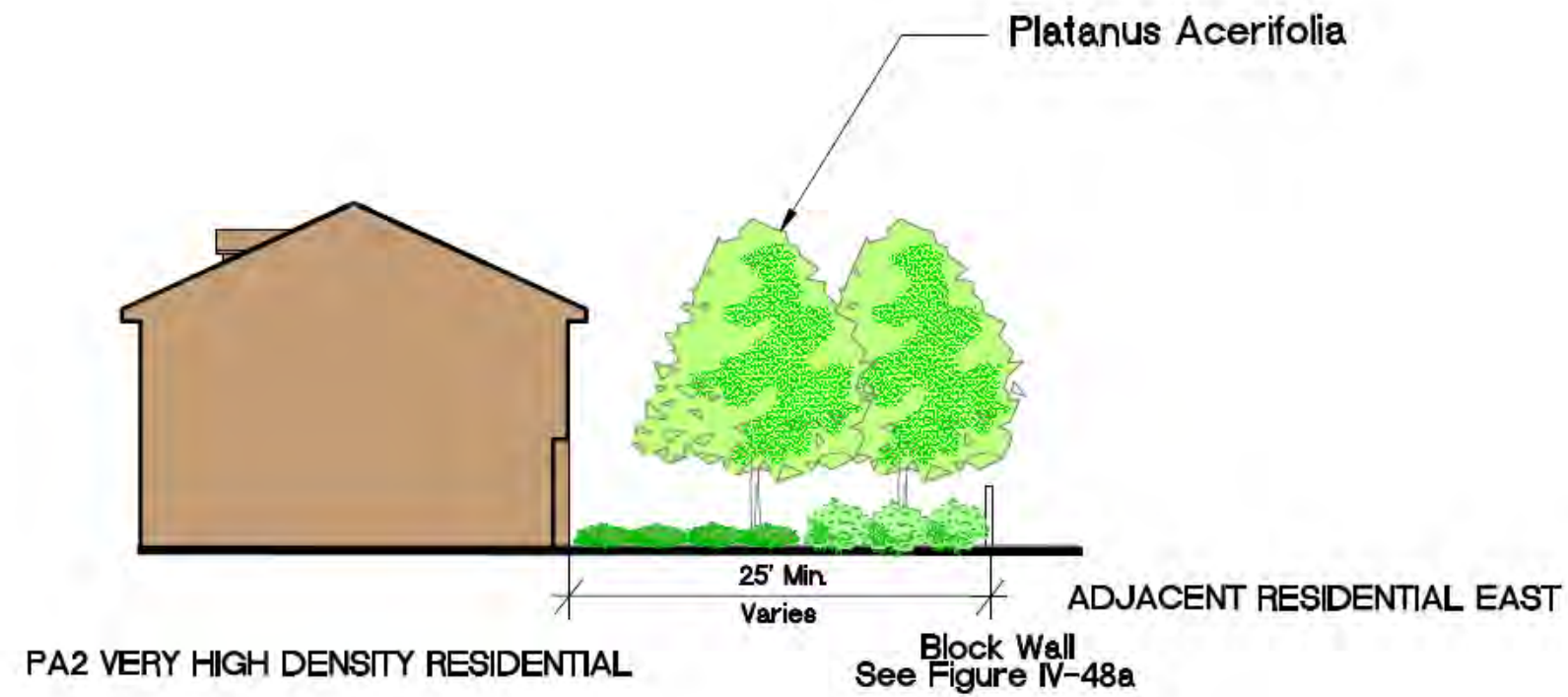

Note: Shrub and groundcover species shall be selected from the approved Plant Palette Table IV-1, as derived from the Riverside County California Friendly Plant List.

PA2 VERY HIGH DENSITY RESIDENTIAL - ADJACENT RESIDENTIAL
EDGE CONDITION, EASTERN - FIGURE IV-33

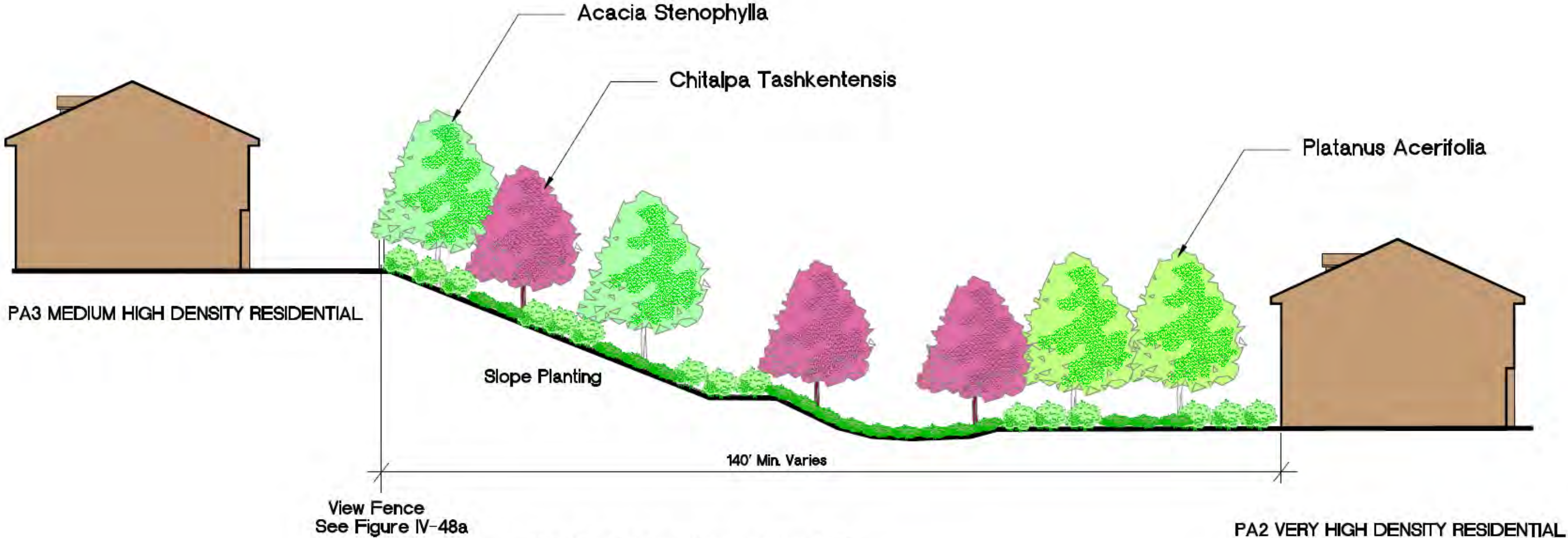

Note: Shrub and groundcover species shall be selected from the approved Plant Palette Table IV-1, as derived from the Riverside County California Friendly Plant List.

PA2 VERY HIGH DENSITY RESIDENTIAL -
PA3 MEDIUM HIGH DENSITY RESIDENTIAL EDGE CONDITION - FIGURE IV-34



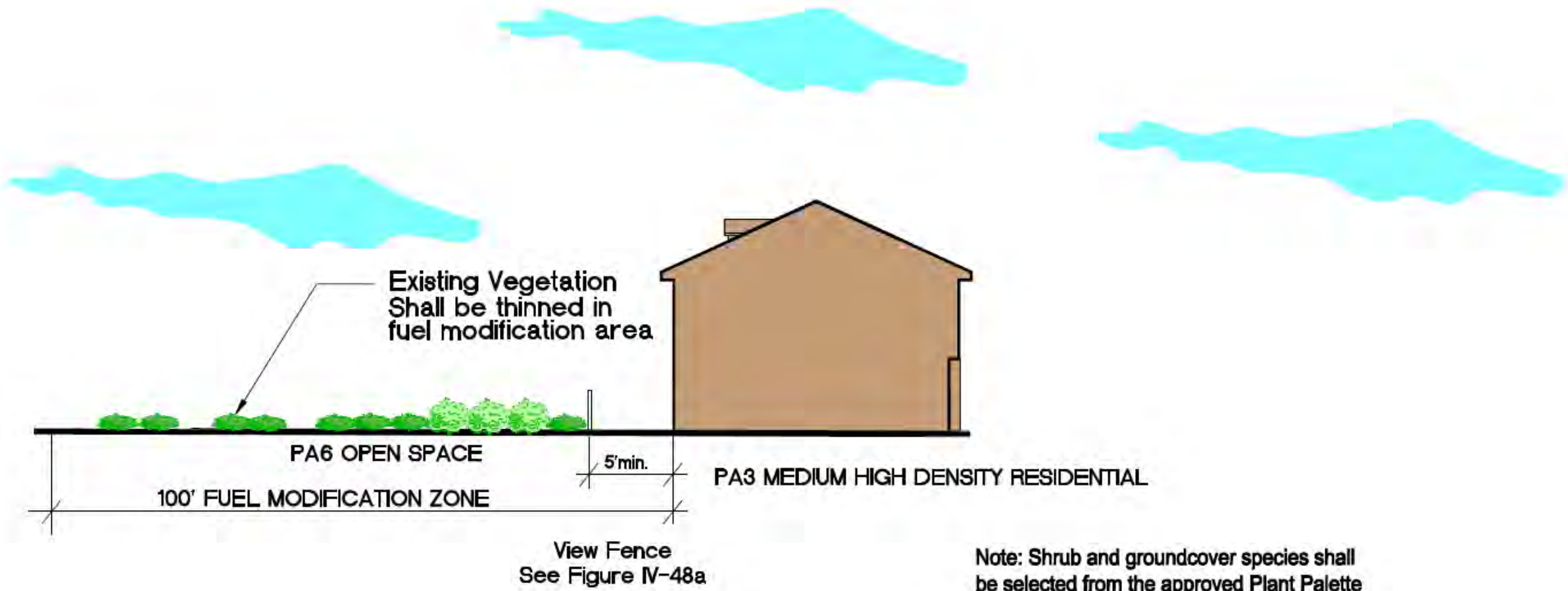

Note: Shrub and groundcover species shall be selected from the approved Plant Palette Table IV-1, as derived from the Riverside County California Friendly Plant List.

PA3 MEDIUM HIGH DENSITY RESIDENTIAL -
PA6 OPEN SPACE EDGE CONDITION - FIGURE IV-35



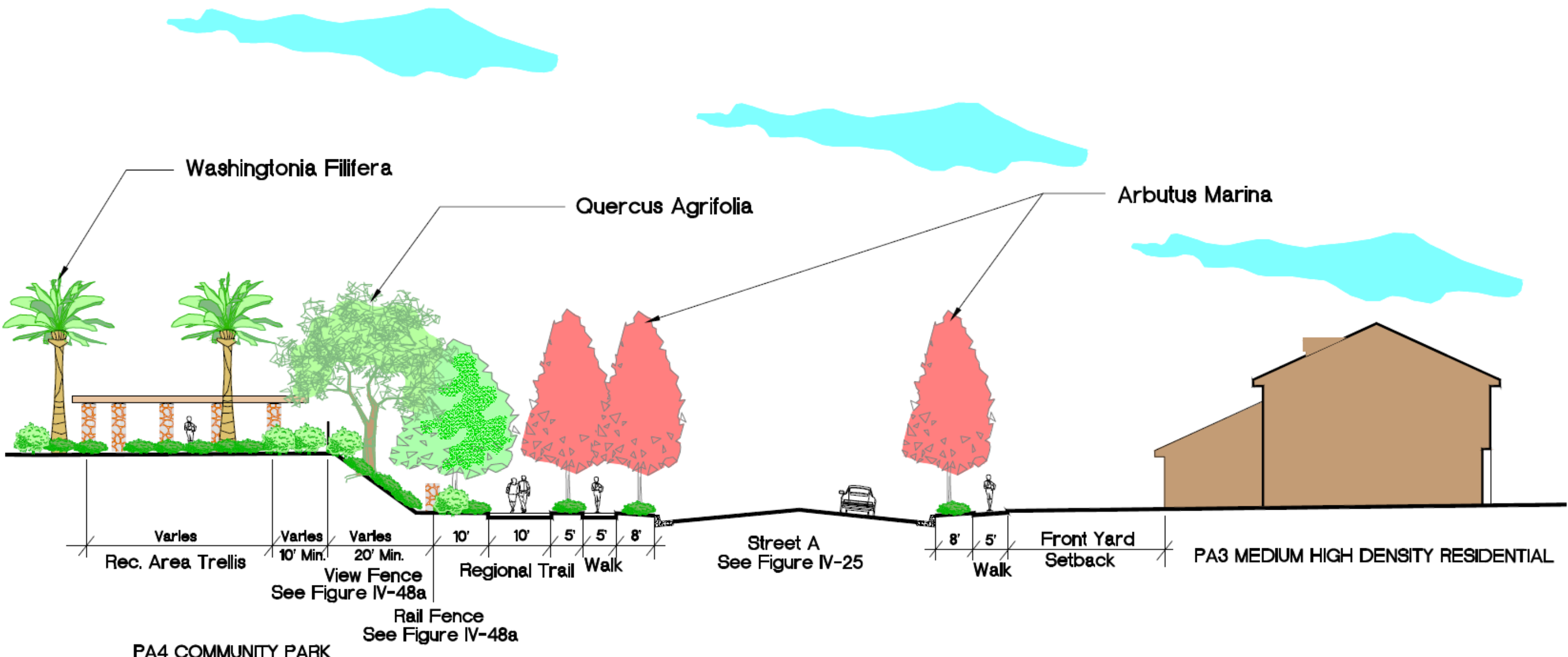

Note: Shrub and groundcover species shall be selected from the approved Plant Palette Table IV-1, as derived from the Riverside County California Friendly Plant List.



PA3 MEDIUM HIGH DENSITY RESIDENTIAL - PA4 COMMUNITY PARK EDGE CONDITION - FIGURE IV-36

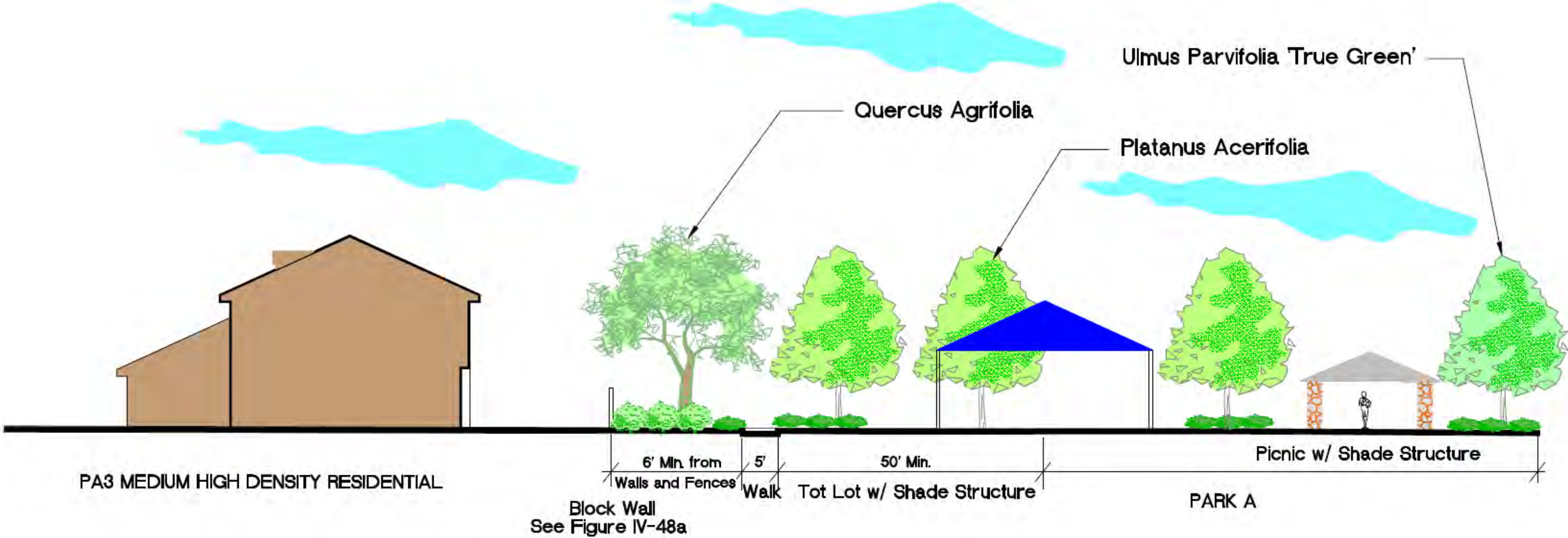

Note: Shrub and groundcover species shall be selected from the approved Plant Palette Table IV-1, as derived from the Riverside County California Friendly Plant List.

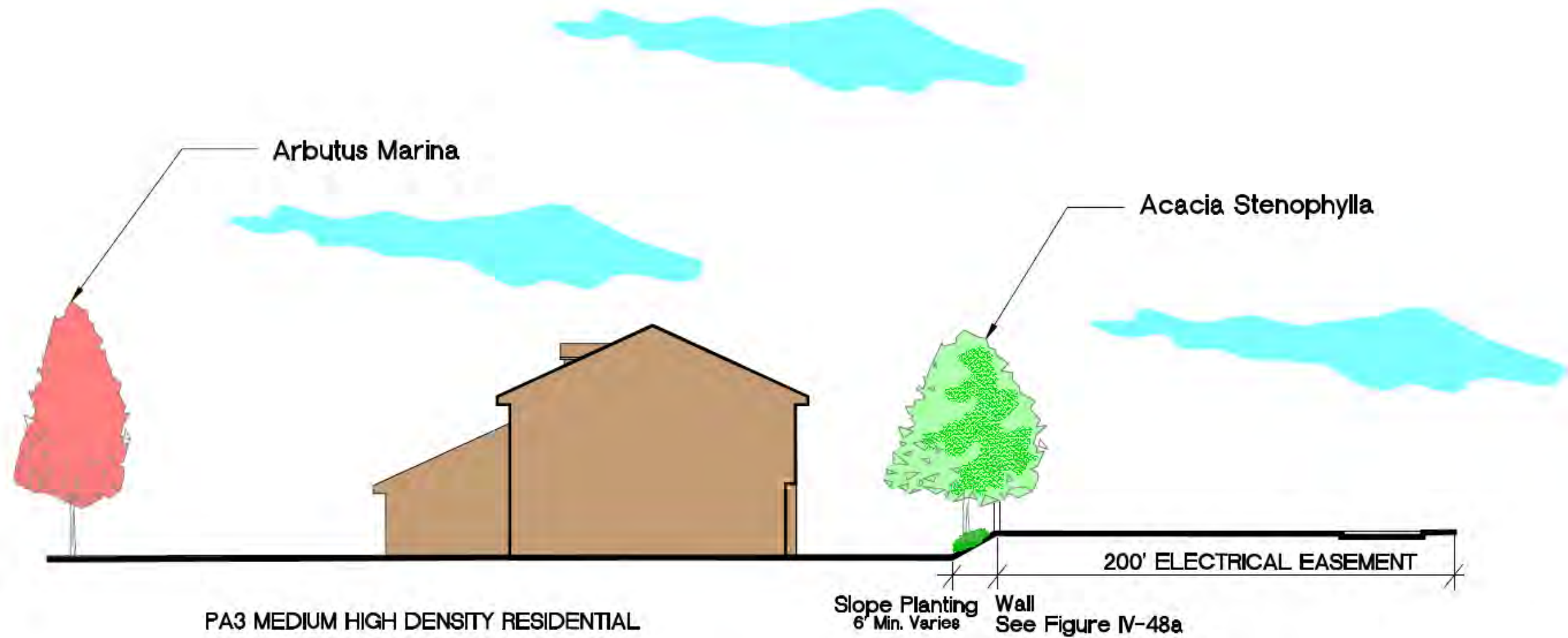

PA3 MEDIUM HIGH DENSITY RESIDENTIAL

Slope Planting
6' Min. Varies
Wall
See Figure IV-48a

200' ELECTRICAL EASEMENT

Note: Shrub and groundcover species shall be selected from the approved Plant Palette Table IV-1, as derived from the Riverside County California Friendly Plant List.

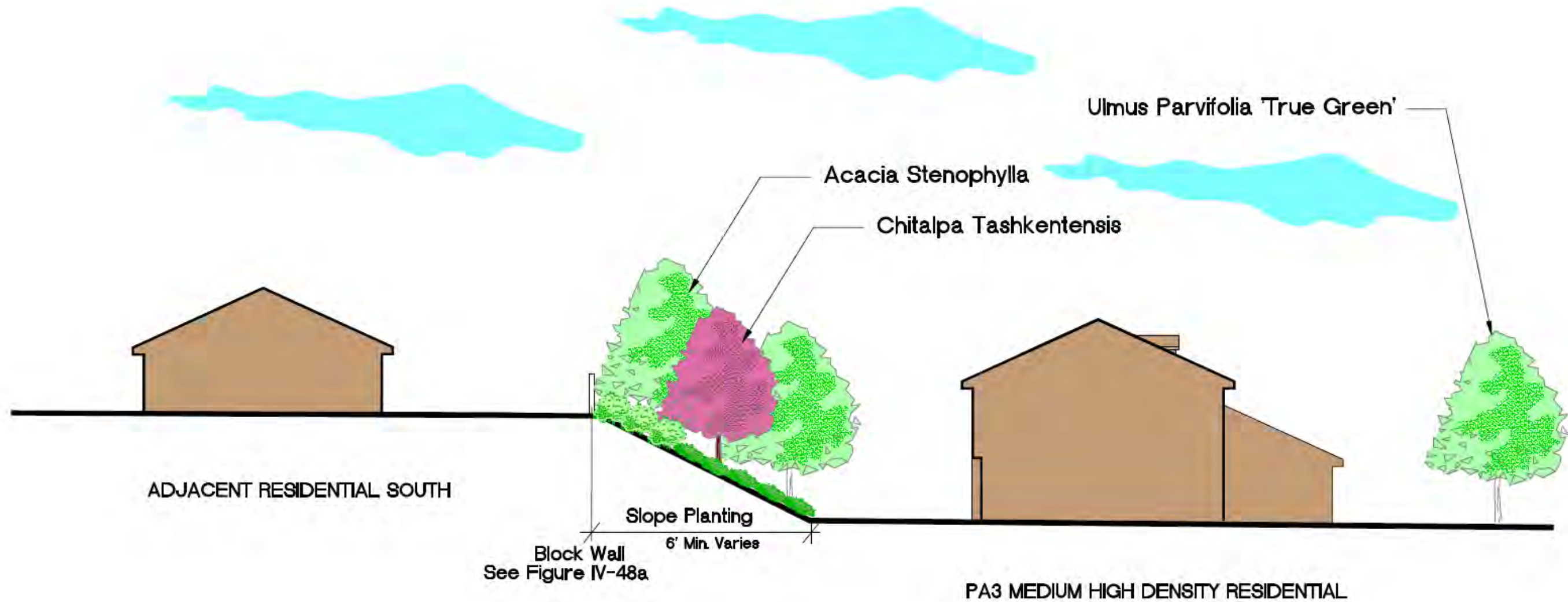

Note: Shrub and groundcover species shall be selected from the approved Plant Palette Table IV-1, as derived from the Riverside County California Friendly Plant List.

PA5 MEDIUM DENSITY RESIDENTIAL - ADJACENT RESIDENTIAL EDGE CONDITION - FIGURE IV-39

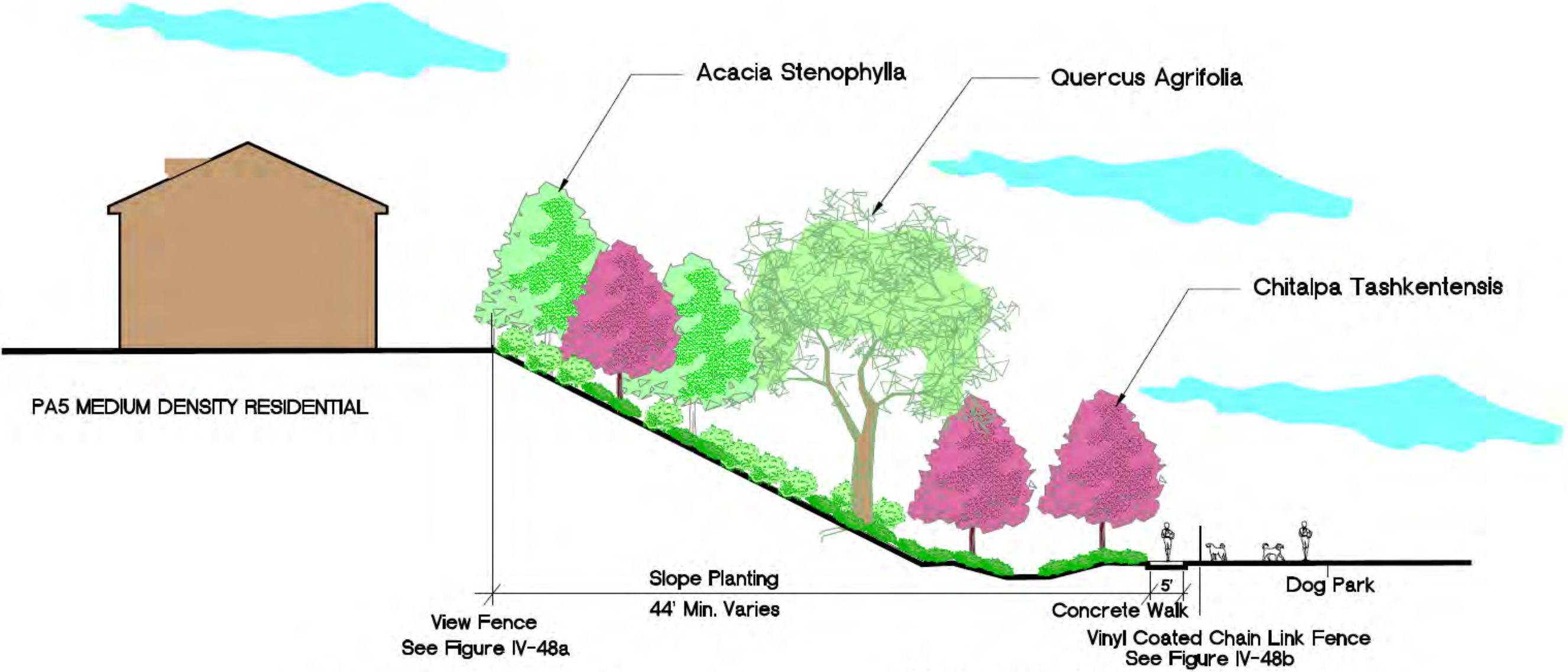

Note: Shrub and groundcover species shall be selected from the approved Plant Palette Table IV-1, as derived from the Riverside County California Friendly Plant List.

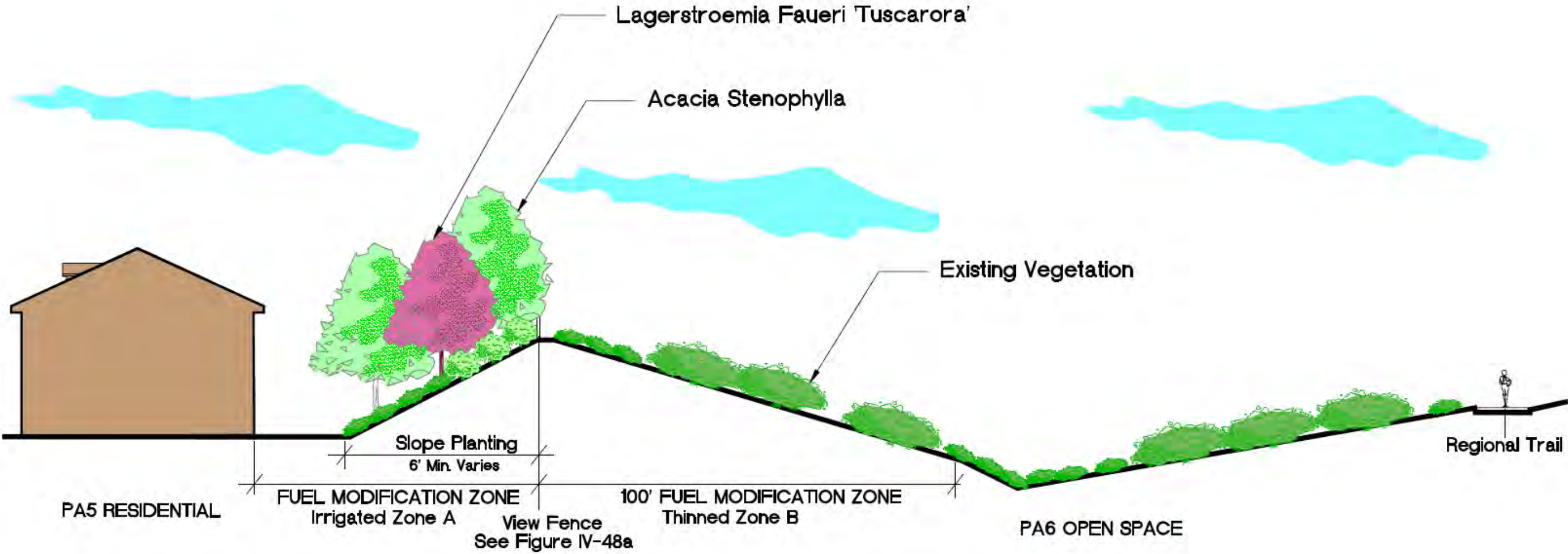

Note: Shrub and groundcover species shall be selected from the approved Plant Palette Table IV-1, as derived from the Riverside County California Friendly Plant List.



PA5 MEDIUM DENSITY RESIDENTIAL -
PA6 OPEN SPACE EDGE CONDITION - FIGURE IV-41



Note: Shrub and groundcover species shall be selected from the approved Plant Palette Table IV-1, as derived from the Riverside County California Friendly Plant List.





Rock Scramble Play Area



Waterfall



Tot Lot



Water Spalsh Play Area



Dog Park



Dog Park



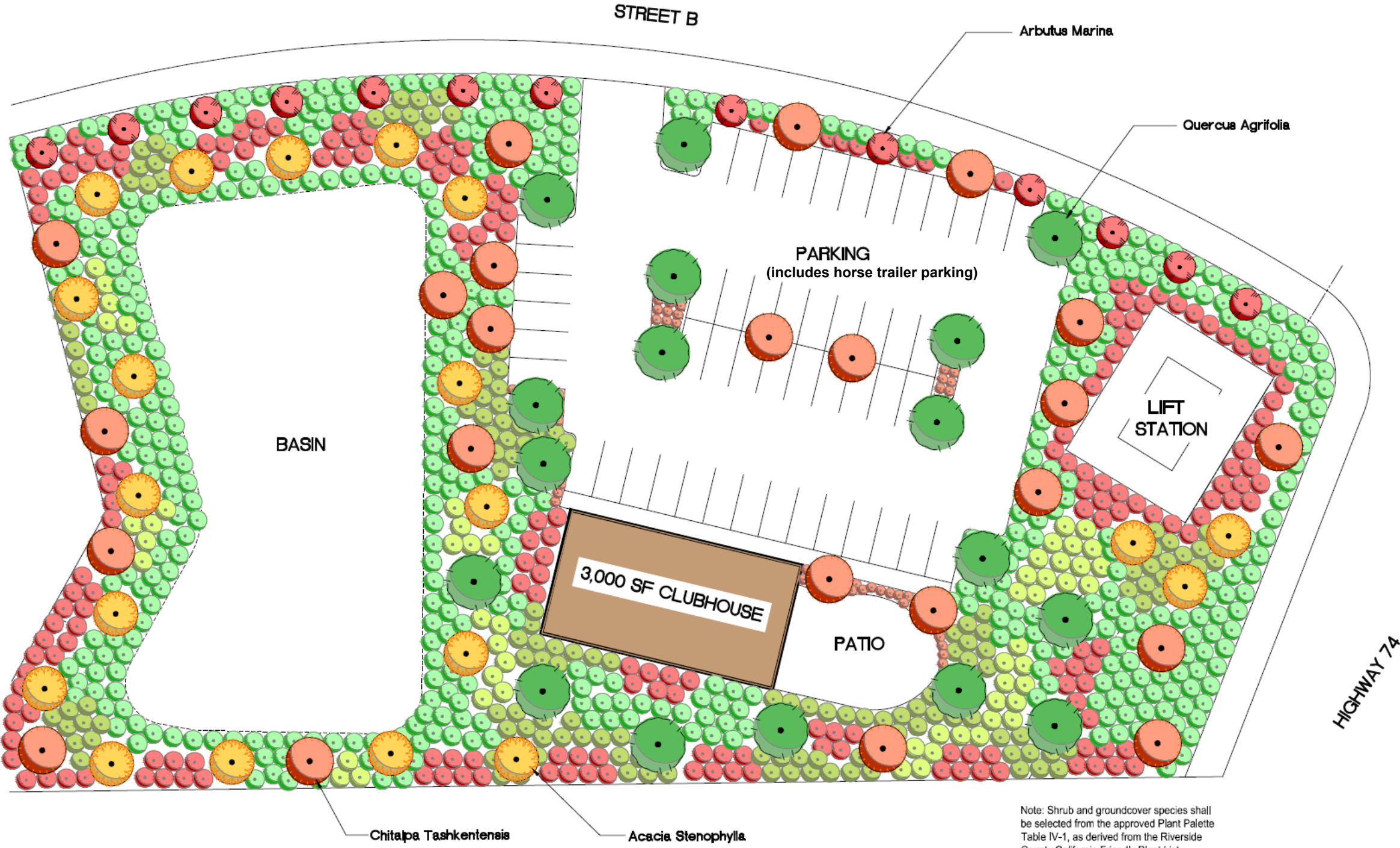



Note: Shrub and groundcover species shall be selected from the approved Plant Palette Table IV-1, as derived from the Riverside County California Friendly Plant List.

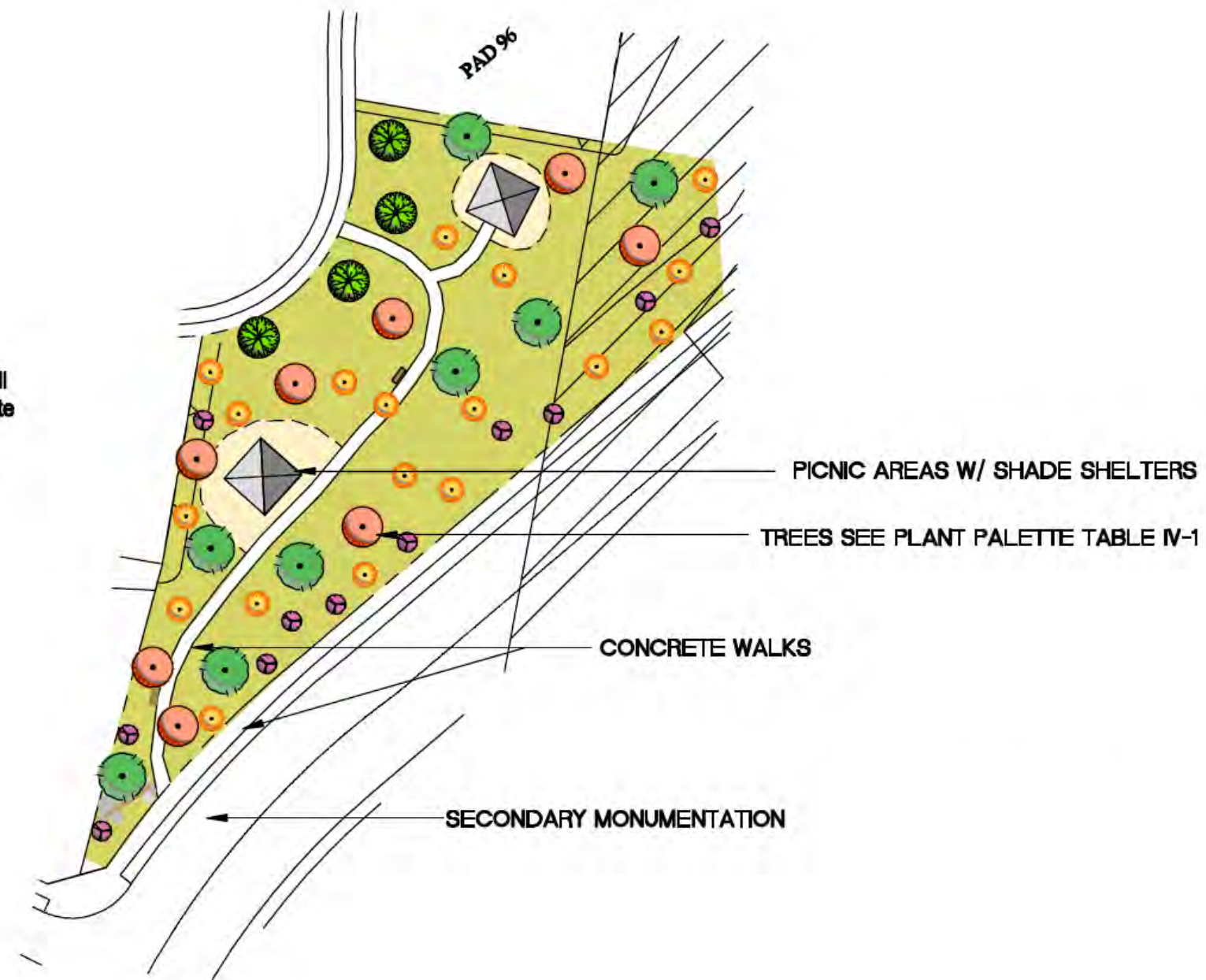

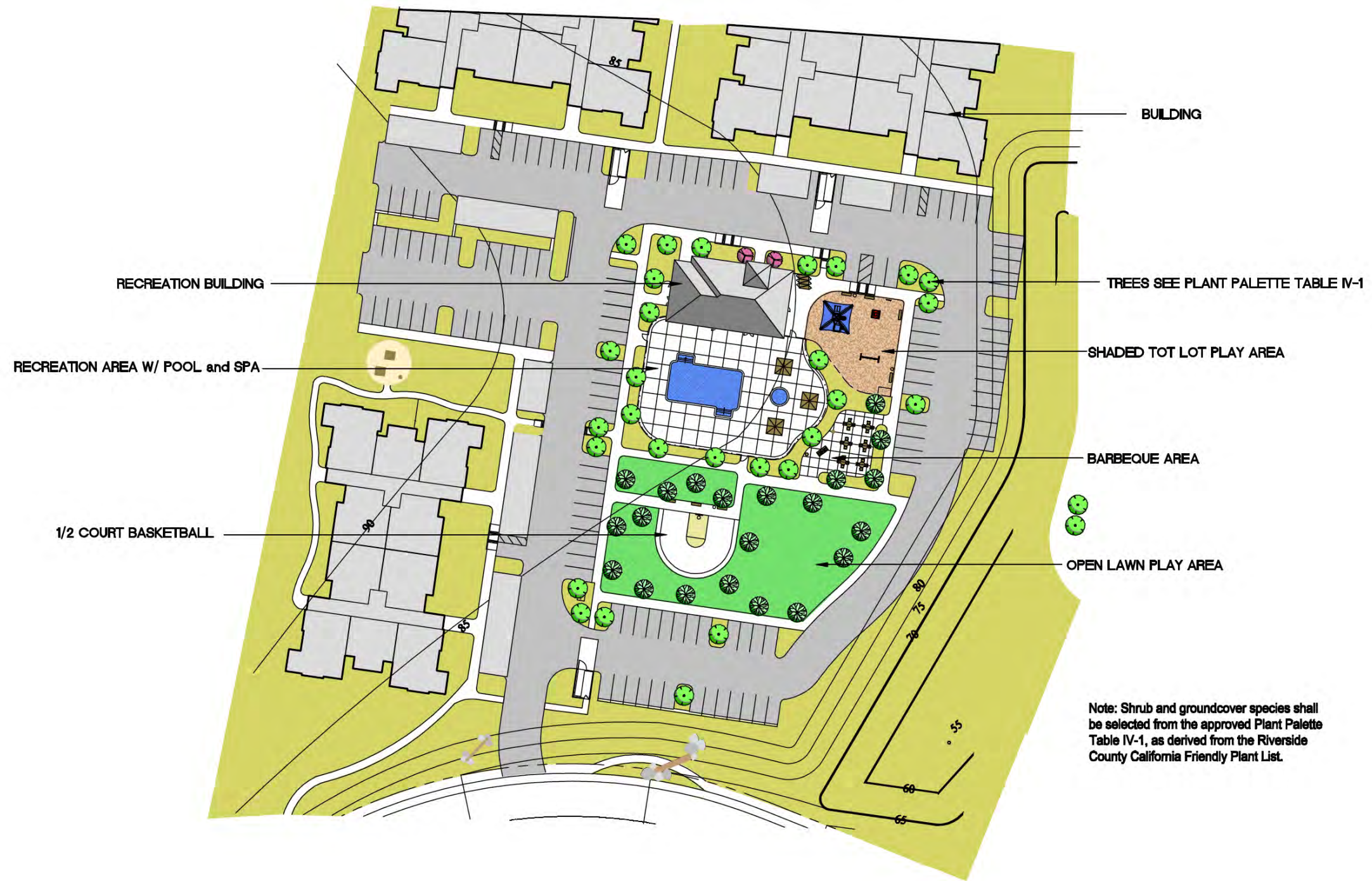

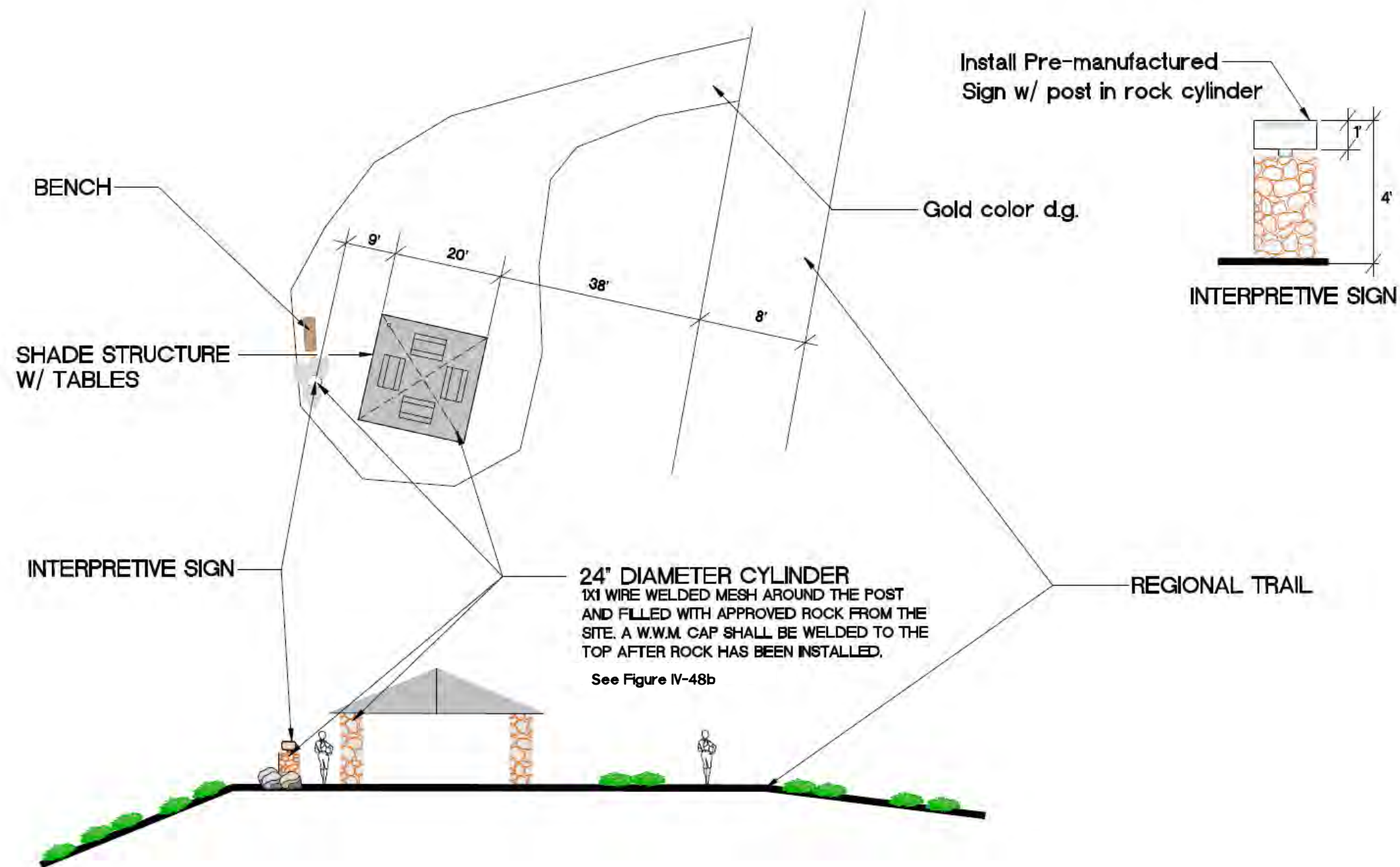



Bollard Style Trail Light



Crookneck Trail Lighting



Nostalgic Trail lighting



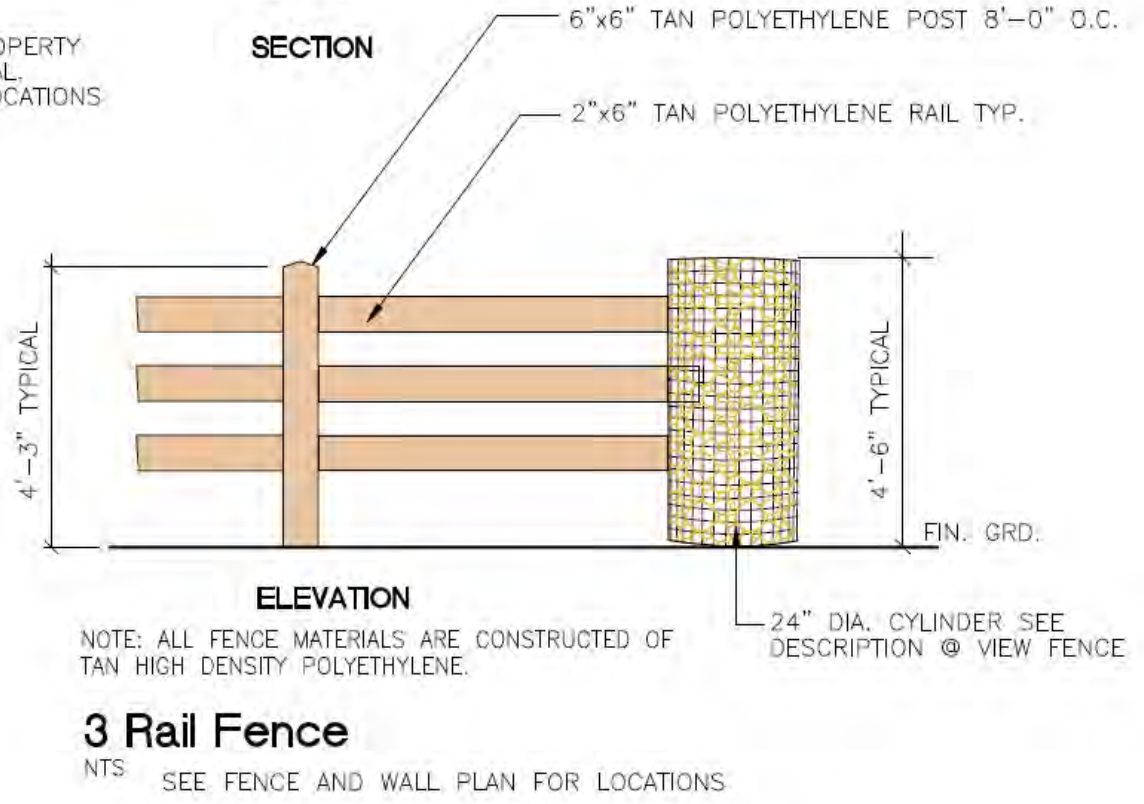
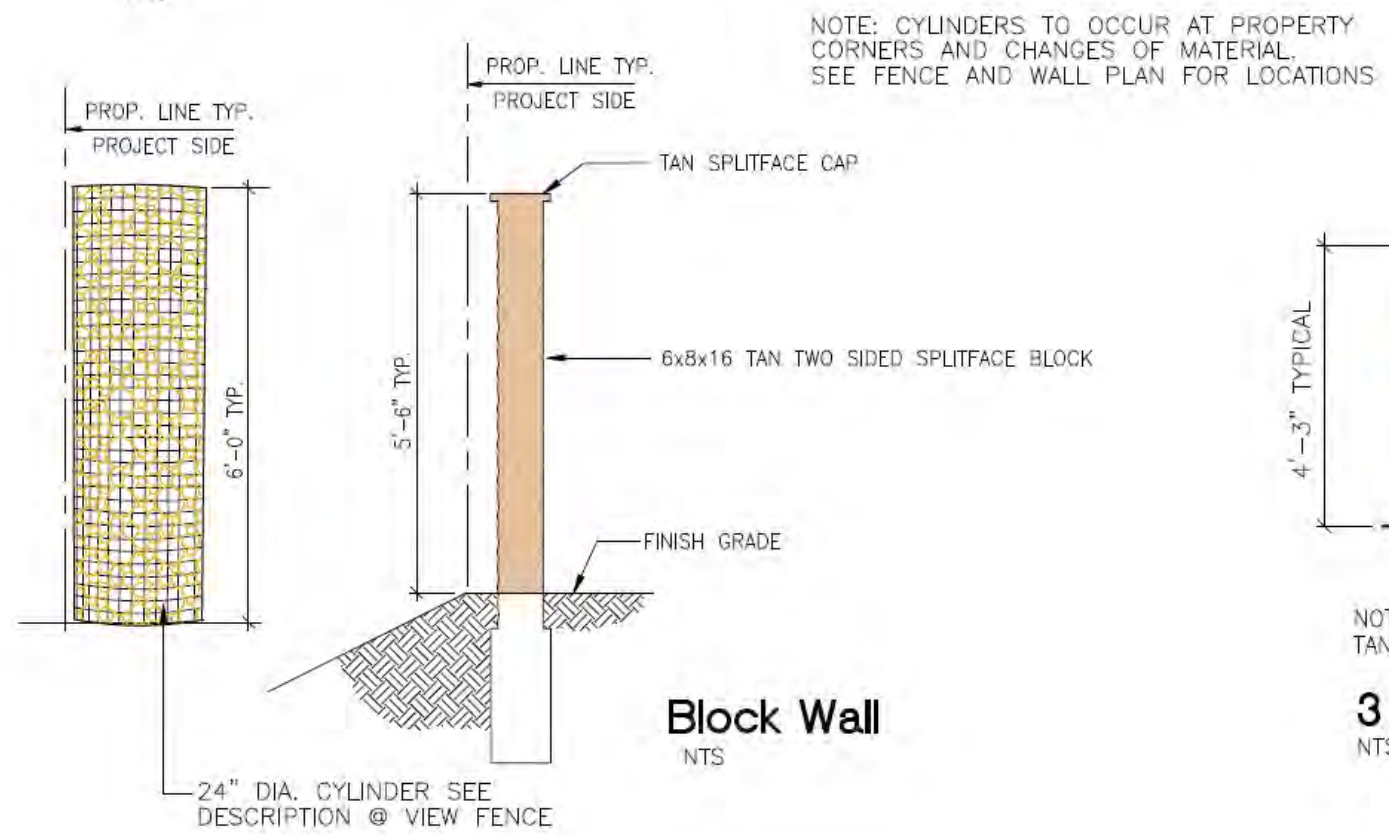
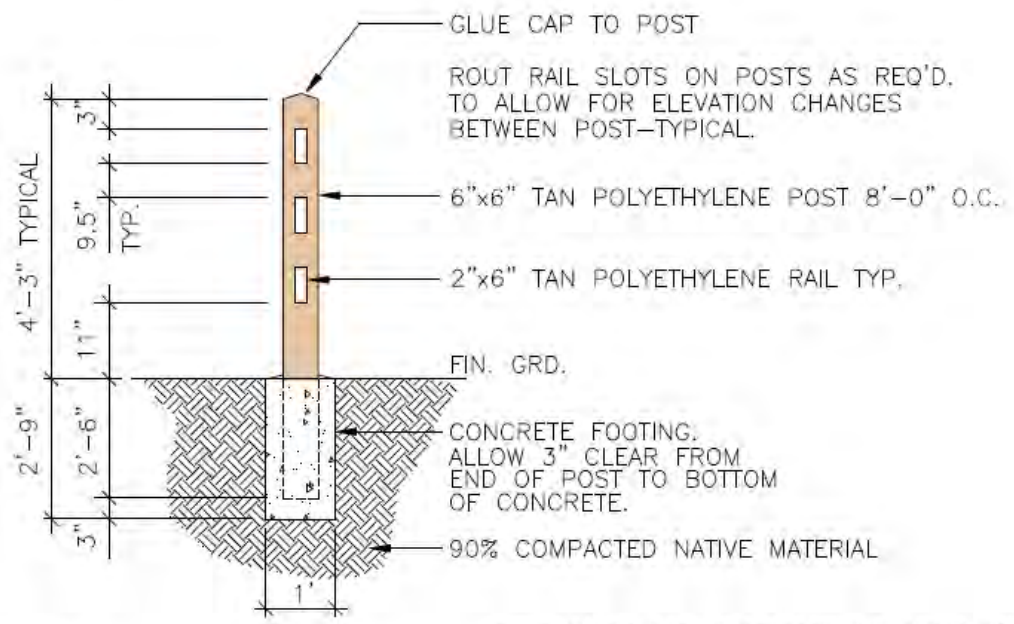
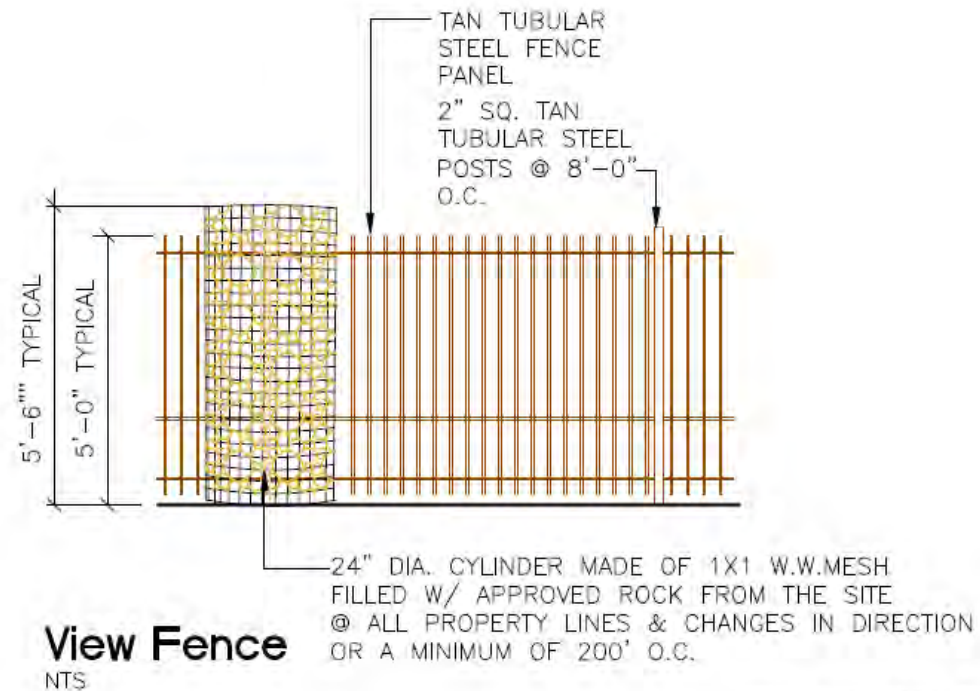

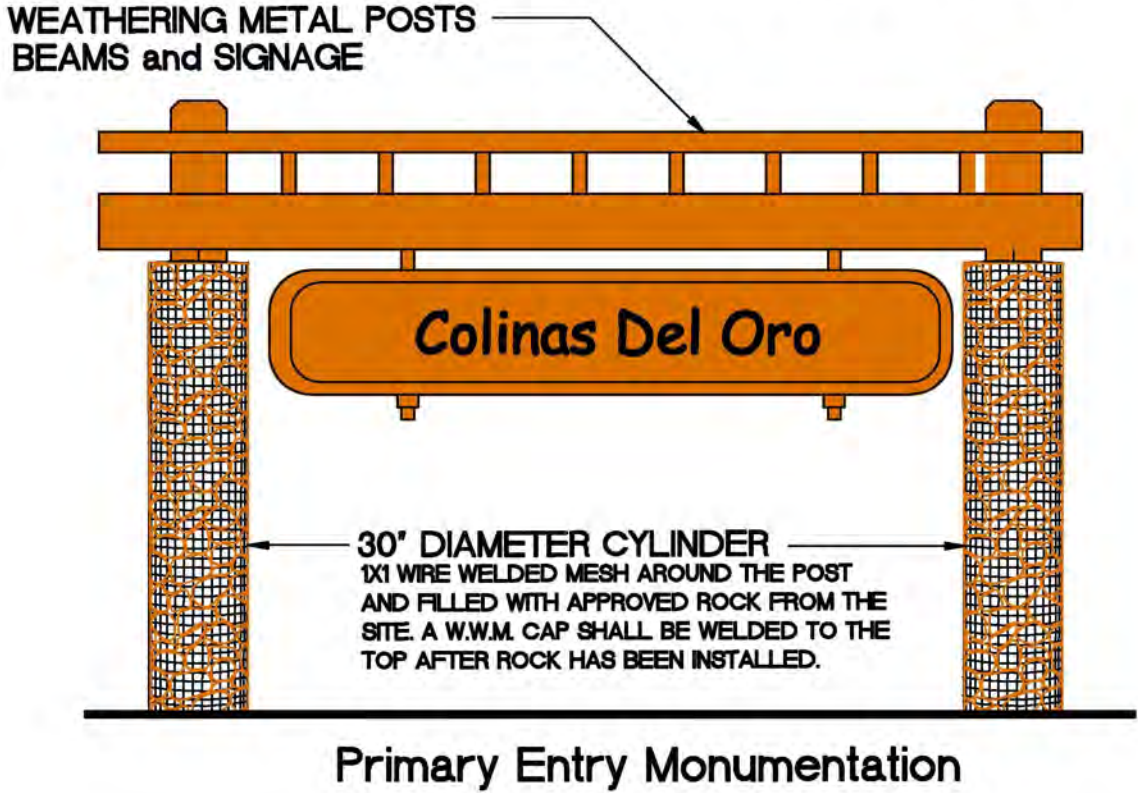
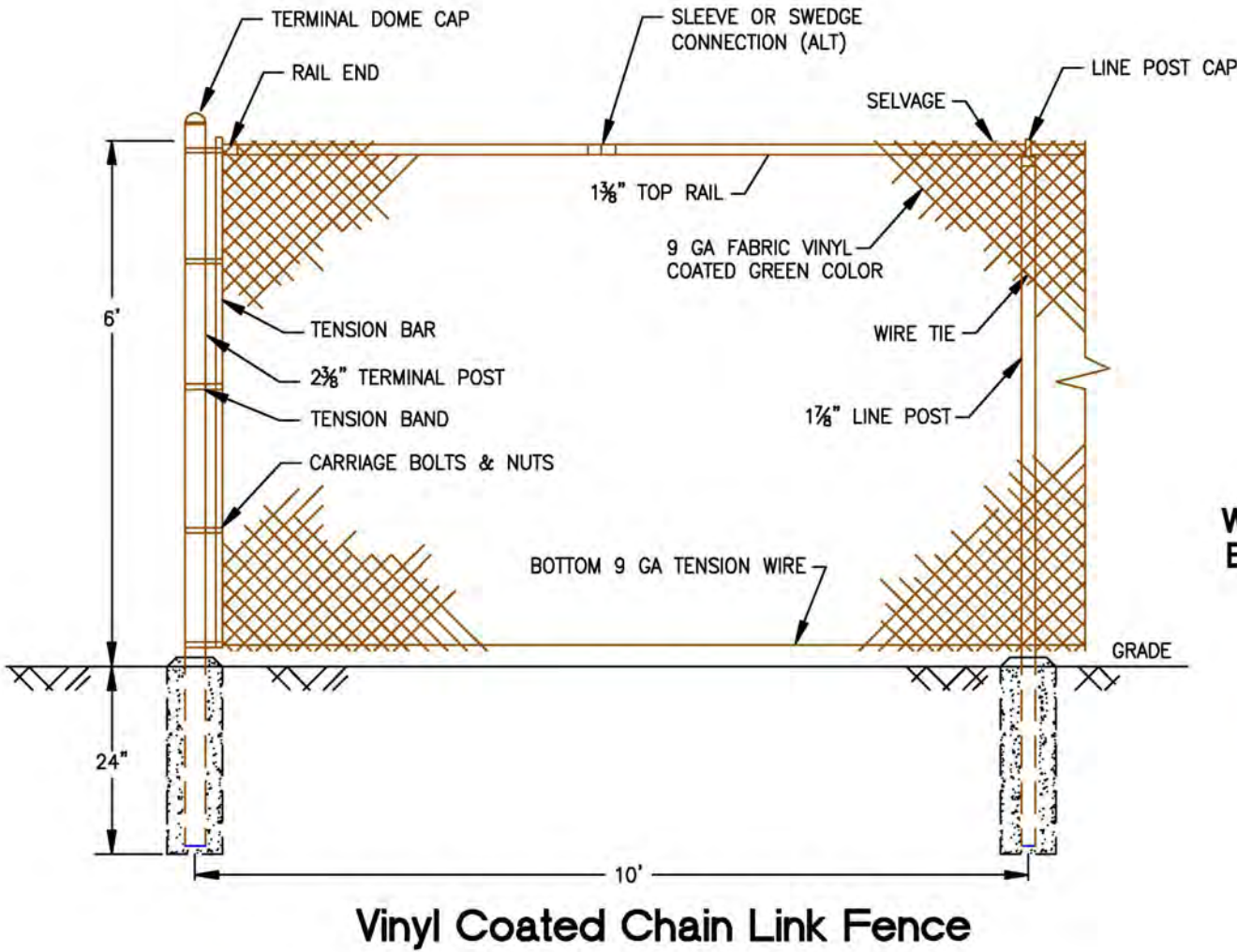



Use of Rocks



Colored Gravel and Native Vegetaion



Native Vegetation



Use of Cobbles and Stone





Commercial Wall Pack Lighting



Commercial Signage Lighting



Commercial Center Lighting



Commercial Parking Lot Lighting



Residential Street Lighting



Trellis Arbor with Landscaping



Arched Arbor with Landscaping

