

# Section III - Development Plans and Standards

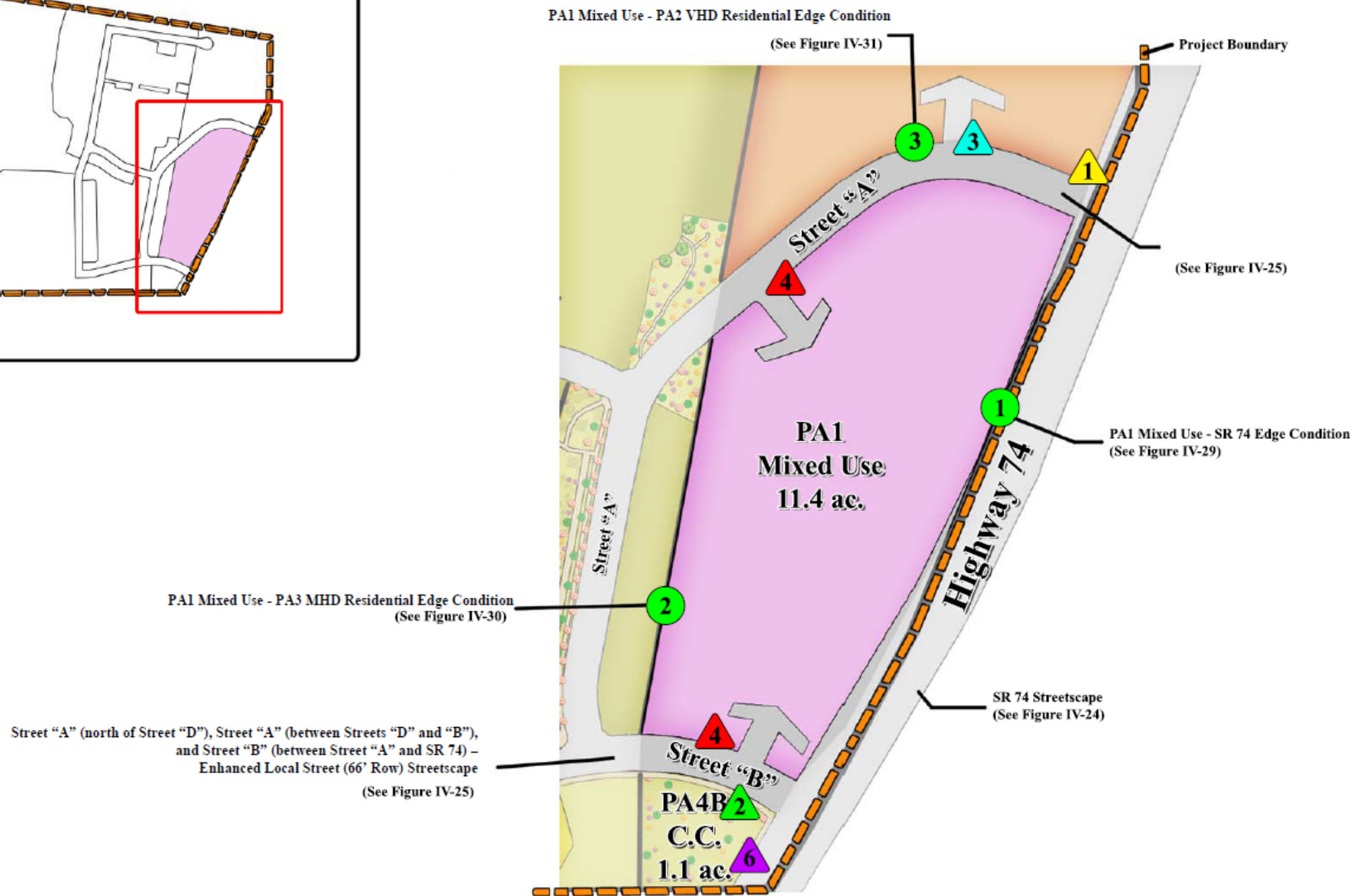

- Major Entry Monumentation (See Figure IV-19) ▲ 1
- Secondary Entry Monumentation (See Figure IV-20) ▲ 2
- Neighborhood Entry Monumentation (See Figure IV-21) ▲ 3
- Commercial Entry Monumentation (See Figure IV-22) ▲ 4
- Trail Entry Monumentation (See Figure IV-23) ▲ 6

Note: Please see Figure II-2, Roadway Cross-Sections for road section standards

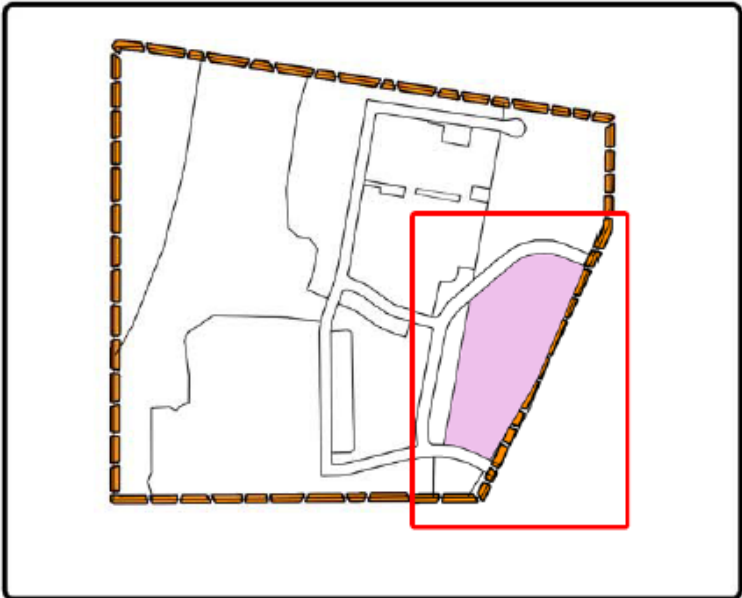

# Section III - Development Plans and Standards

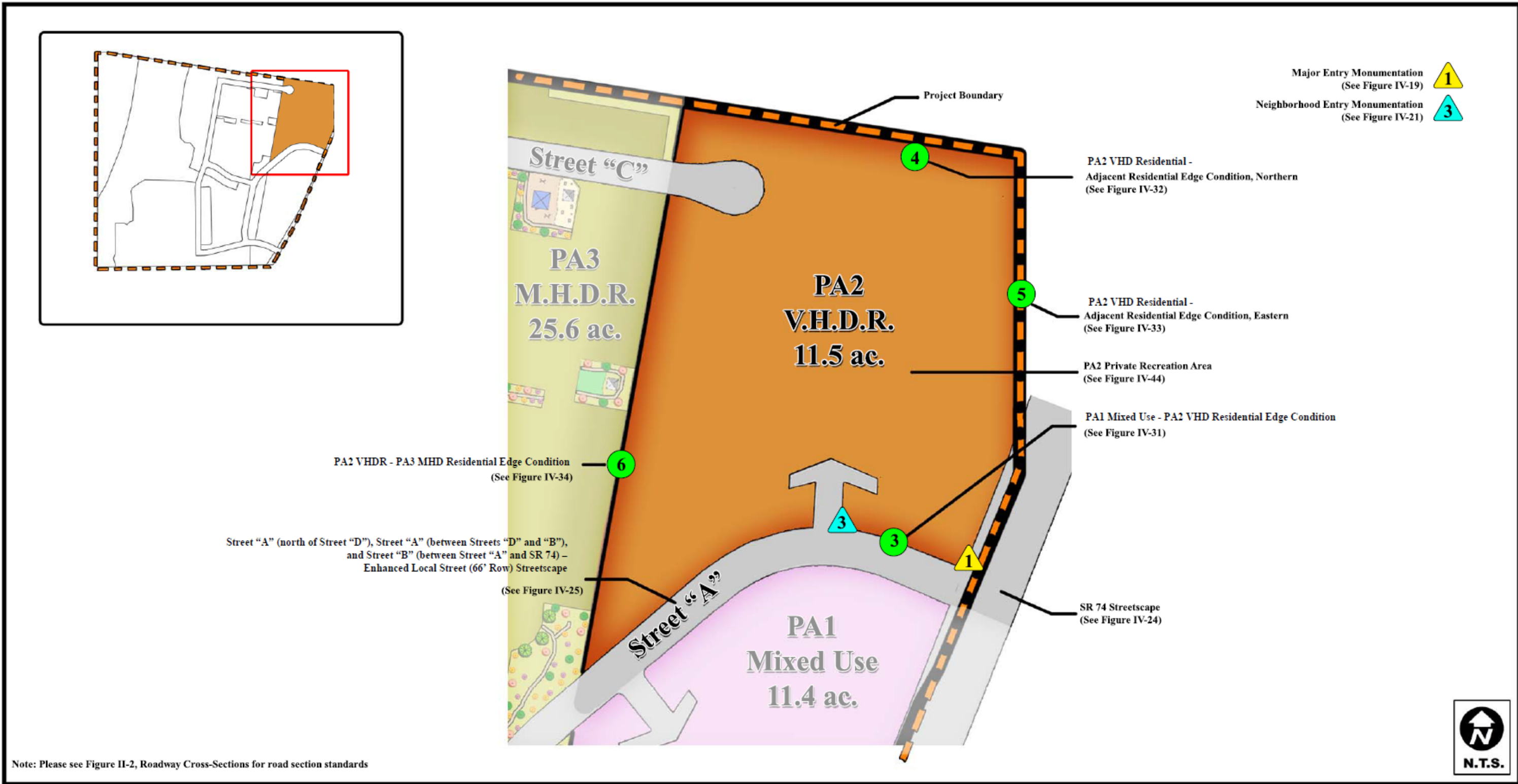



# Section III - Development Plans and Standards

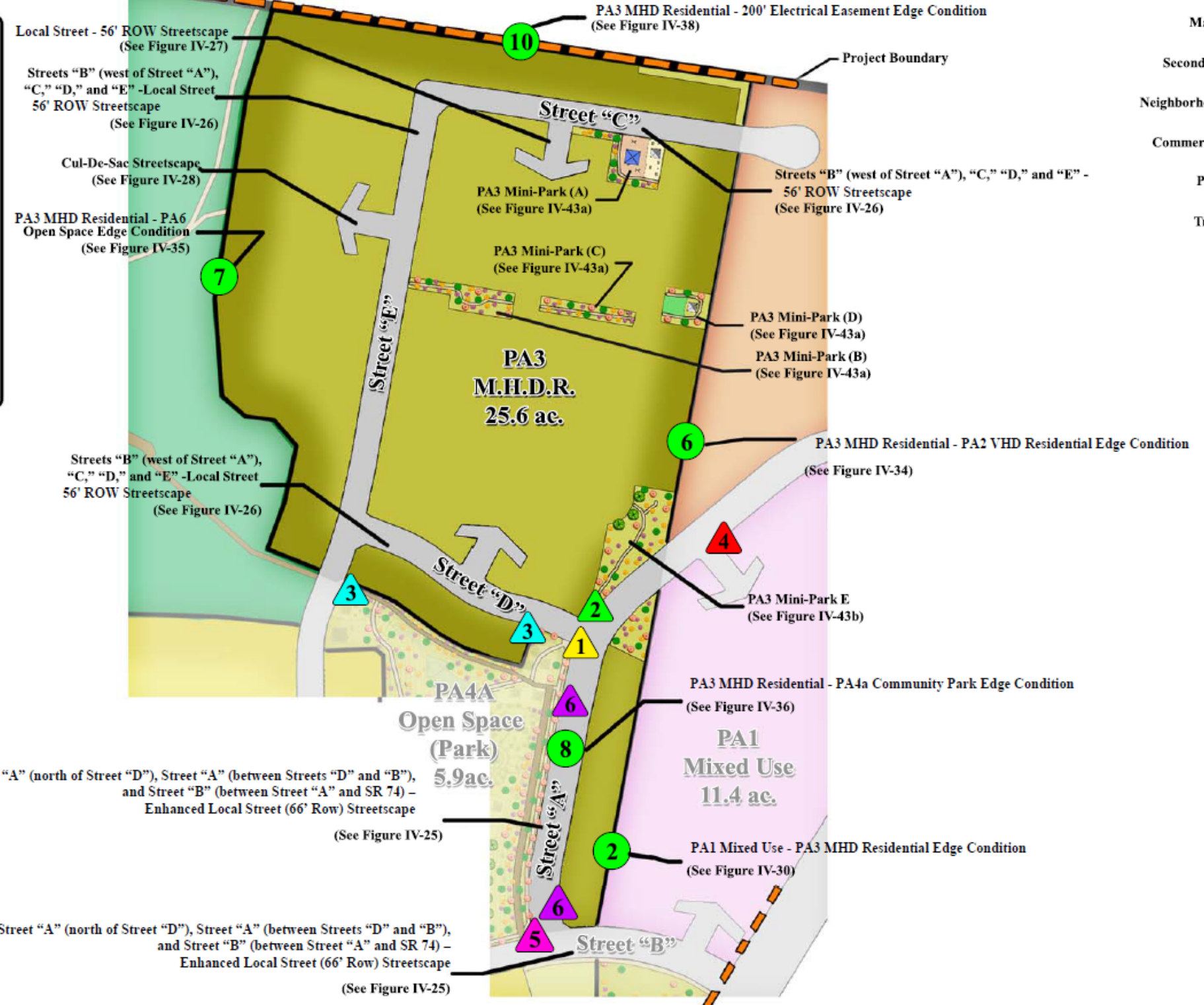

- Major Entry Monumentation (See Figure IV-19)
- Secondary Entry Monumentation (See Figure IV-20)
- Neighborhood Entry Monumentation (See Figure IV-21)
- Commercial Entry Monumentation (See Figure IV-22)
- Park Entry Monumentation (See Figure IV-23)
- Trail Entry Monumentation (See Figure IV-23)
- Community Trail (See Figure II-4)

Note: Please see Figure II-2, Roadway Cross-Sections for road section standards



**PLANNING AREA 3 - MEDIUM HIGH DENSITY RESIDENTIAL (5-8 DU/AC) - FIGURE III-3**



Section III - Development Plans and Standards

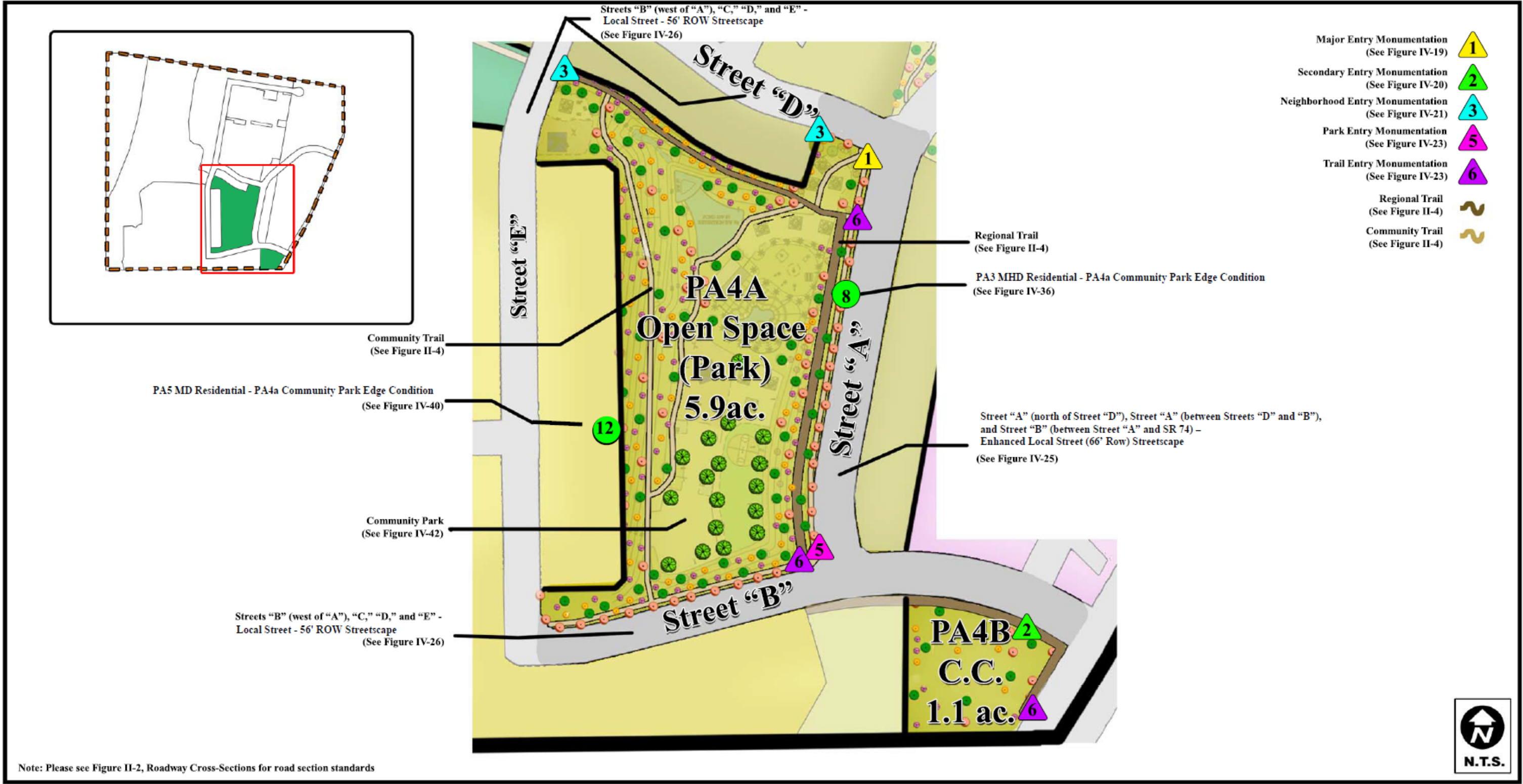



# Section III - Development Plans and Standards

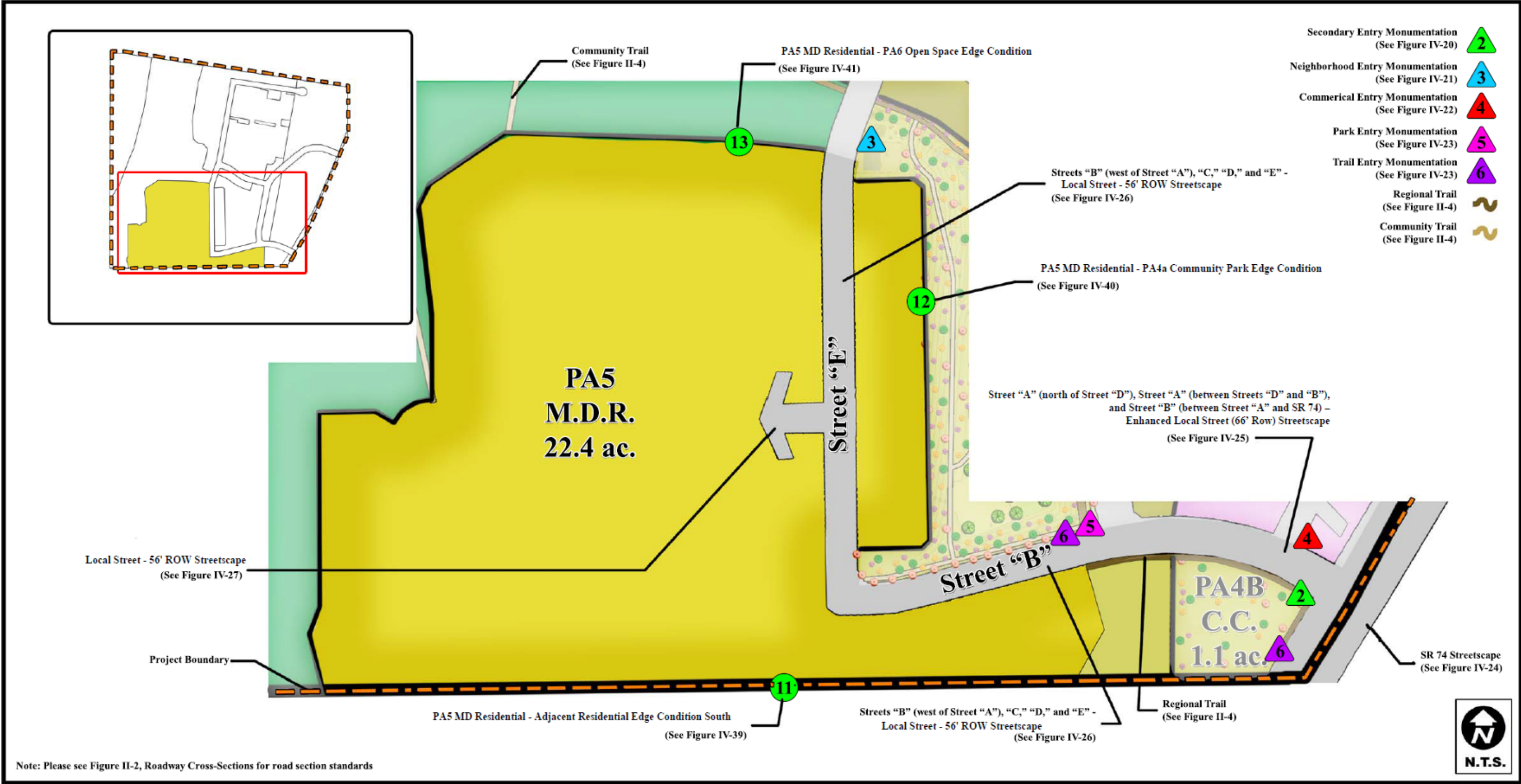

**PLANNING AREA 5 - MEDIUM DENSITY RESIDENTIAL (2-5 DU/AC) - FIGURE III-5**

# Section III - Development Plans and Standards

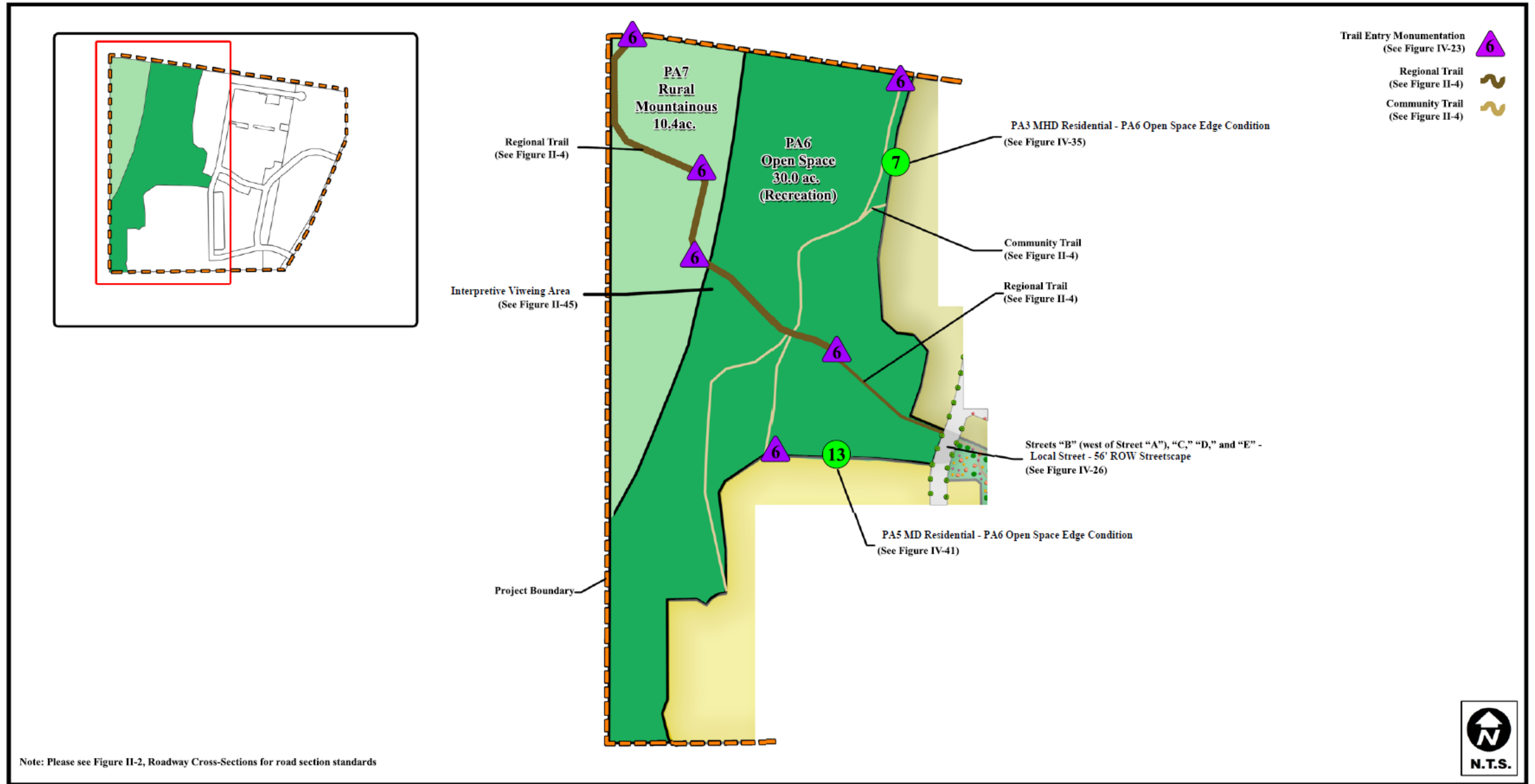

**PLANNING AREAS 6 AND 7 - OPEN SPACE-RECREATION AND RURAL MOUNTAINOUS- FIGURE III-6**