

**18. PLANNING AREA 18 — Executive Golf Course and
Championship Golf Course**

a. Descriptive Summary

Planning Area 18 consists of a 9-hole approximately 3300 yard championship length golf course to be built at the initial stage of Phase II (A) development. Additionally, in the northern most portion of the Planning Area 18 an additional 9-hole approximately 3300 yard championship-length golf course is planned to be built as development necessitates. Both golf courses are laid out in a linear fashion to allow maximum frontage of residential lots along the golf course. Golf cart paths will meander throughout the golf courses. Due to safety considerations, the golf courses may not be used for jogging or walking during golf course hours

The golf courses also function as part of the site's drainage system (See Section IV.A.3), and will include lakes serving as a part of the irrigation water system (See Section IV.A.5).

Planning Area 18 will be a common area. The golf course will be deeded to the Master Association and will be operated by the Homeowners Association.

b. Land Use and Development Standards

Land Use:	18-Hole Championship Golf Course and 9-hole Championship Golf Course (See Zoning, Section III)
Acreage:	173.20 ±
Density:	N.A.
Number of Units:	0

c. Design Guidelines

1. The golf course will be designed to take into account neighboring residences, both in terms of creating views and in terms of minimizing hazards to the residents.
2. Planning Area 18 may include neighborhood streets needed to provide adequate access to neighboring planning areas.
3. See Design Guidelines, Section IV.C.4 (c) for landscape guidelines relating to the golf course.
4. Planning Area 18 will also incorporate some greenbelt/open space areas that will act as part of the drainage collection and dispersion facilities.

Del Webb's
Sun City Palm Springs

PLANNING AREA 18 PHASE II 173.20 AC.

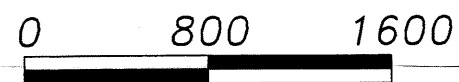
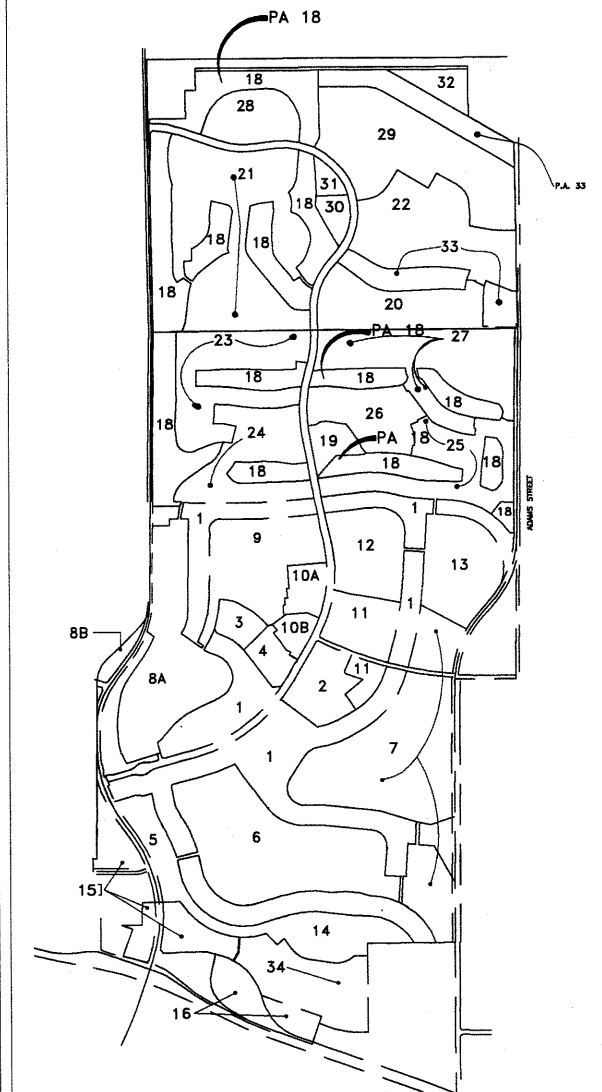
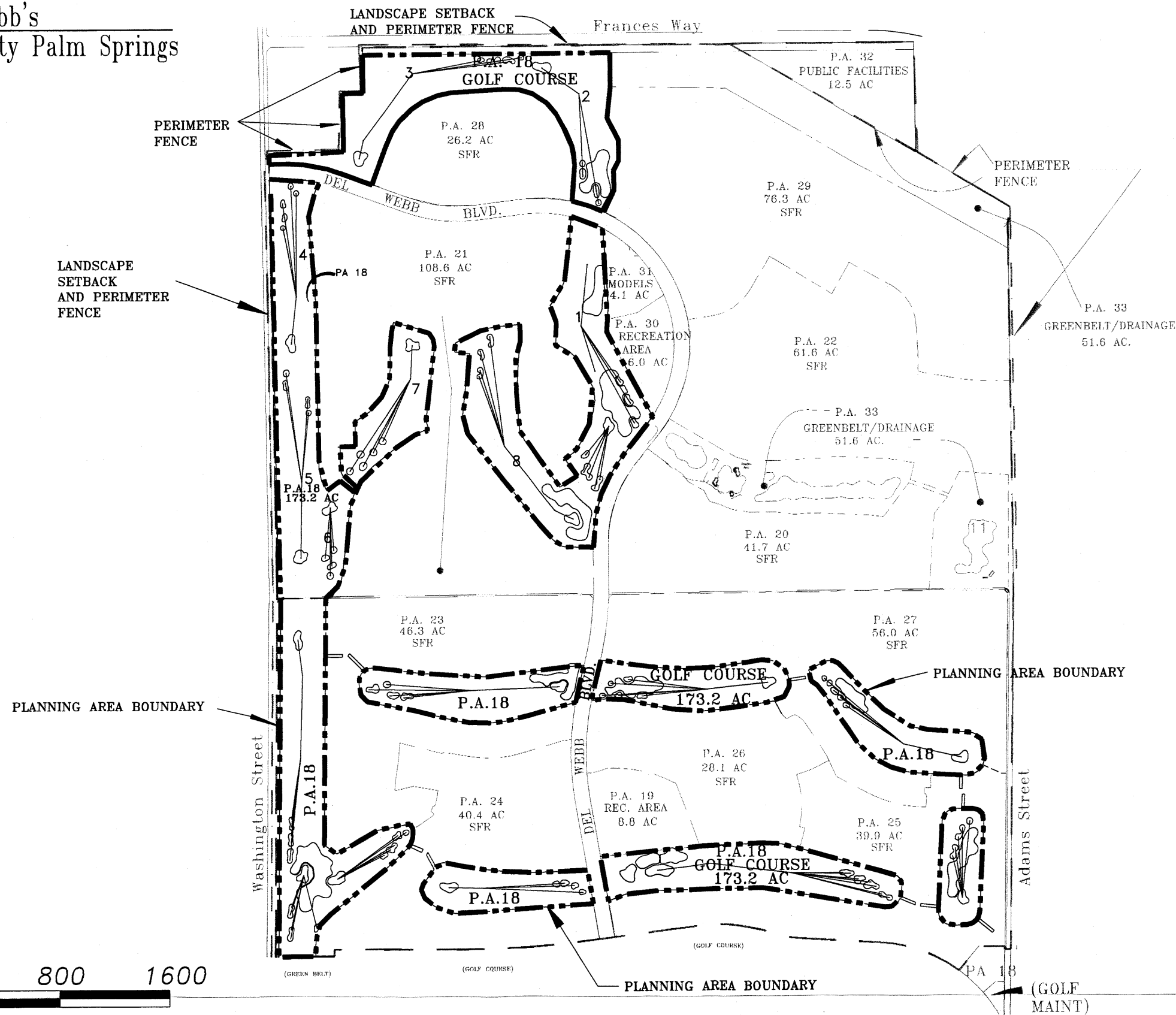

FIGURE IV-47