

SECTION 19, T. 4S., R. 6E., S. B. B. & M.

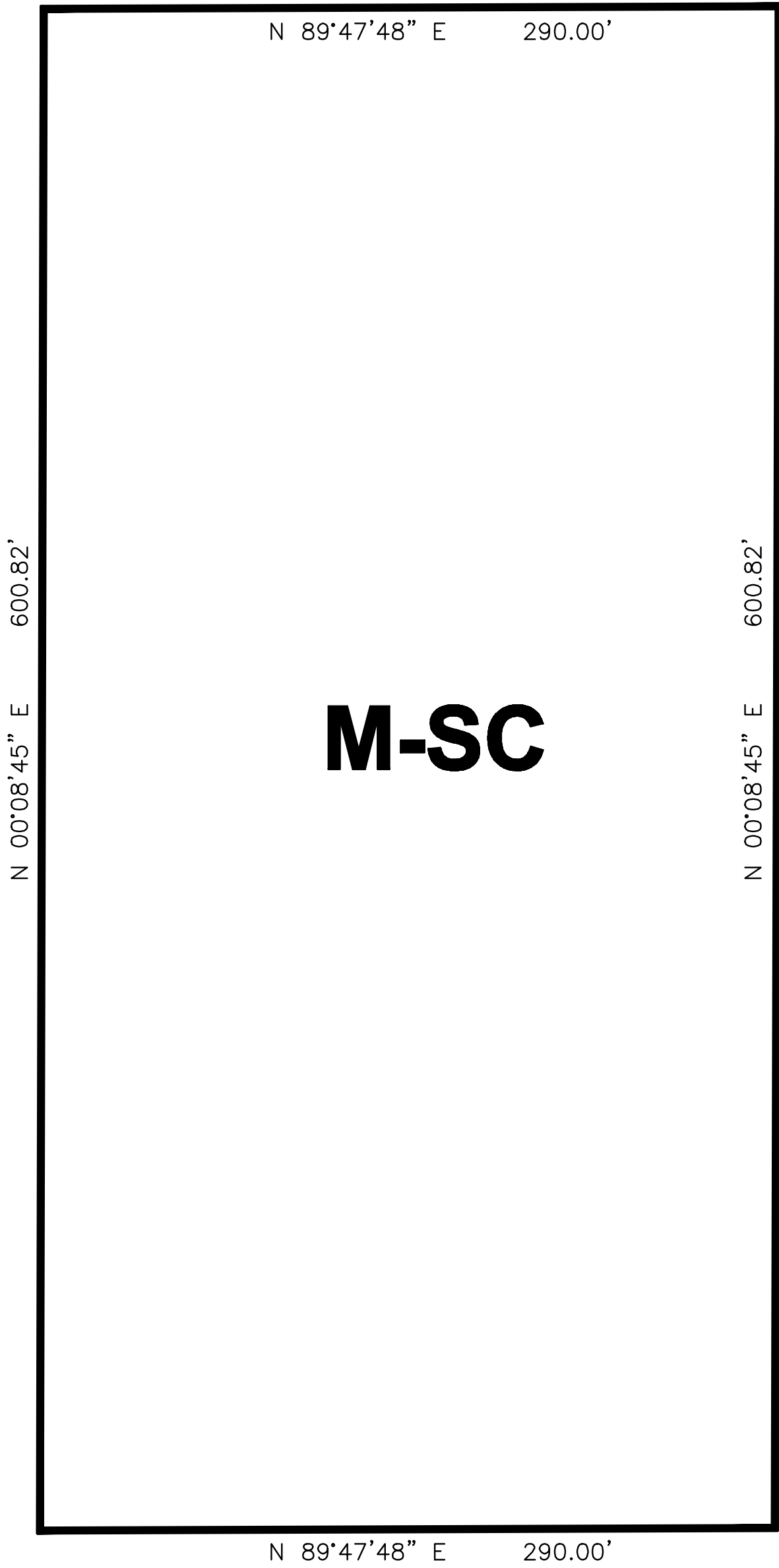

LEGAL DESCRIPTION
PARCEL 3, OF RECORD OF SURVEY, AS SHOWN BY MAP ON FILE IN BOOK 35, AT PAGE 14, OF RECORDS OF SURVEY, RIVERSIDE COUNTY RECORDS, LOCATED IN THE NORTH HALF OF SECTION 19, TOWNSHIP 4 SOUTH, RANGE 6 EAST, IN THE UNINCORPORATED TERRITORY OF THE COUNTY OF RIVERSIDE, STATE OF CALIFORNIA, SAN BERNARDINO BASE AND MERIDIAN.

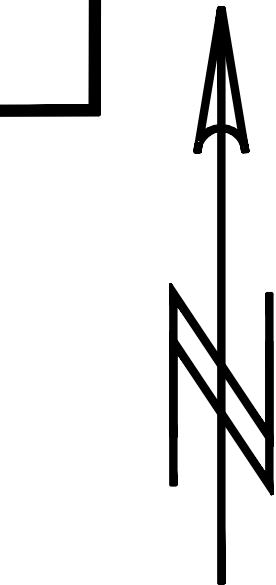

SCALE 1" = 50'

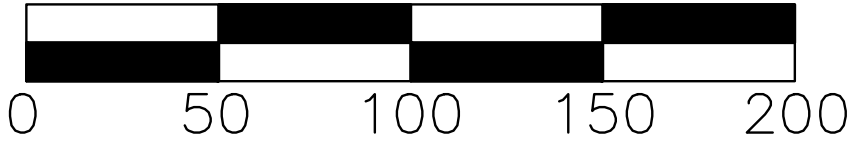

LEGEND

M-SC **MANUFACTURING - SERVICE COMMERCIAL**

MAP NO. 40.044
CHANGE OF OFFICIAL ZONING PLAN
THOUSAND PALMS
DISTRICT
CHANGE OF ZONE CASE NO. 07726
AMENDING ORDINANCE NO. 348
ADOPTED BY ORDINANCE NO. 348.4782
JULY 1, 2014

RIVERSIDE COUNTY BOARD OF SUPERVISORS