

CHANGE OF OFFICIAL ZONING PLAN

EL CERRITO DISTRICT MAP NO. 45.028
 AMENDING ORDINANCE NO. 348
 GLEN IVY, TEMESCAL, ALBERHILL, MEADOWBROOK AREAS
 MAP NO. 2.1829
 AMENDING MAP NO. 2 ORDINANCE NO. 348
 CHANGE OF ZONE CASE NOS. 5845 & 6216
 ADOPTED BY ORDINANCE NO. 348.3663
 JANUARY 24, 1995
 RIVERSIDE COUNTY BOARD OF SUPERVISORS

LEGEND:

R-R	RURAL RESIDENTIAL	R-T	MOBILEHOME SUBDIVISION AND MOBILEHOME PARK	M-R-A	MINERAL RESOURCES AND RELATED MANUFACTURING
R-1	ONE-FAMILY DWELLINGS	C-1/C-P	GENERAL COMMERCIAL	A-1-5	LIGHT AGRICULTURE, 5 AC. MIN. LOT AREA
R-1-20000	ONE-FAMILY DWELLINGS, 20000 SQ. FT. MIN. LOT AREA	C-P-S	SCENIC HIGHWAY COMMERCIAL	A-1-10	LIGHT AGRICULTURE, 10 AC. MIN. LOT AREA
R-A	RESIDENTIAL AGRICULTURAL	C-O	COMMERCIAL OFFICE	W-2	CONTROLLED DEVELOPMENT AREAS
R-A-20000	RESIDENTIAL AGRICULTURAL, 20000 SQ. FT. MIN. LOT AREA	SP	SPECIFIC PLAN	W-2-10	CONTROLLED DEVELOPMENT AREAS, 10 AC. MIN. LOT AREA
R-A-1	RESIDENTIAL AGRICULTURAL, 1 AC. MIN. LOT AREA	IP	INDUSTRIAL PARK	N-A	NATURAL ASSETS
R-A-2 1/2	RESIDENTIAL AGRICULTURAL, 2 1/2 AC. MIN. LOT AREA	M-SC	MANUFACTURING - SERVICE COMMERCIAL	W-1	WATERCOURSE, WATERSHED AND CONSERVATION AREAS
R-A-5	RESIDENTIAL AGRICULTURAL, 5 AC. MIN. LOT AREA	M-M	MANUFACTURING - MEDIUM	N.A.P.	NOT A PART
R-A-10	RESIDENTIAL AGRICULTURAL, 10 AC. MIN. LOT AREA	M-R	MINERAL RESOURCES		CITIES

NOTE: In certain areas of this Zone Change Map, the boundaries of the zoned areas may be imprecise and/or irregular. Nevertheless, these zoning boundaries shall be used as they appear on this map unless they are amended by an officially approved subsequent zone change. Zone boundary lines are intended to follow nearest lot lines unless specifically dimensioned hereon. Any zone boundary adjoining any right-of-way is intended to be in the center of said right-of-way. Where a number follows the zone classification, it indicates the minimum lot area in acres.

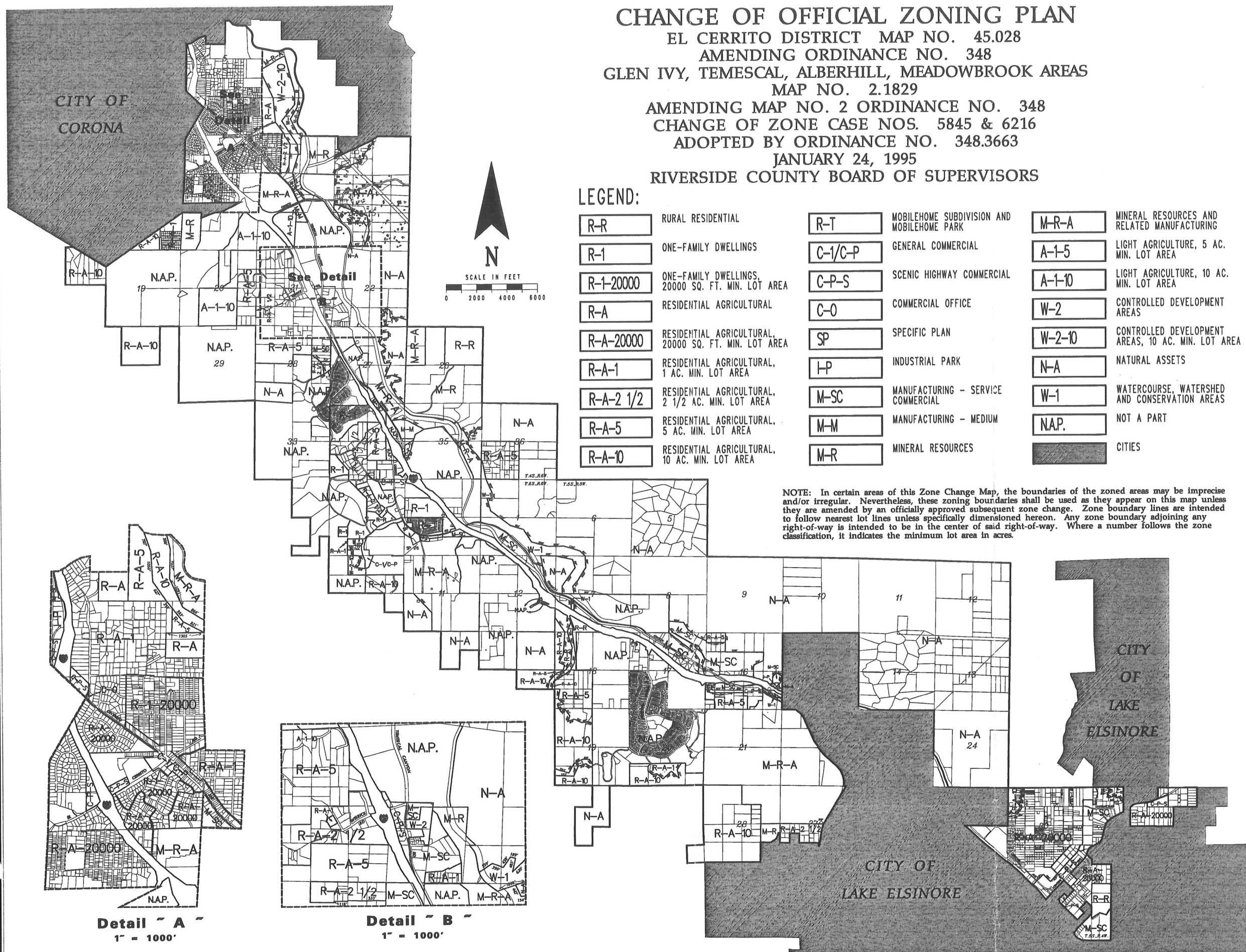

5845 6216