





LEGEND

-  **URBAN ARTERIAL**
Winchester Road & Benton Road
-  **ARTERIAL**
Washington Street
-  **SECONDARY ROAD**
Thompson Road, Auld Road, Pourroy Road, Street 'A', Keller Road, Borel Road, & Leon Road (east of Winchester Road)
-  **TRANSPORTATION CORRIDOR-25-FOOT**
Adjacent to Winchester Road
-  **BUS TURNOUT**

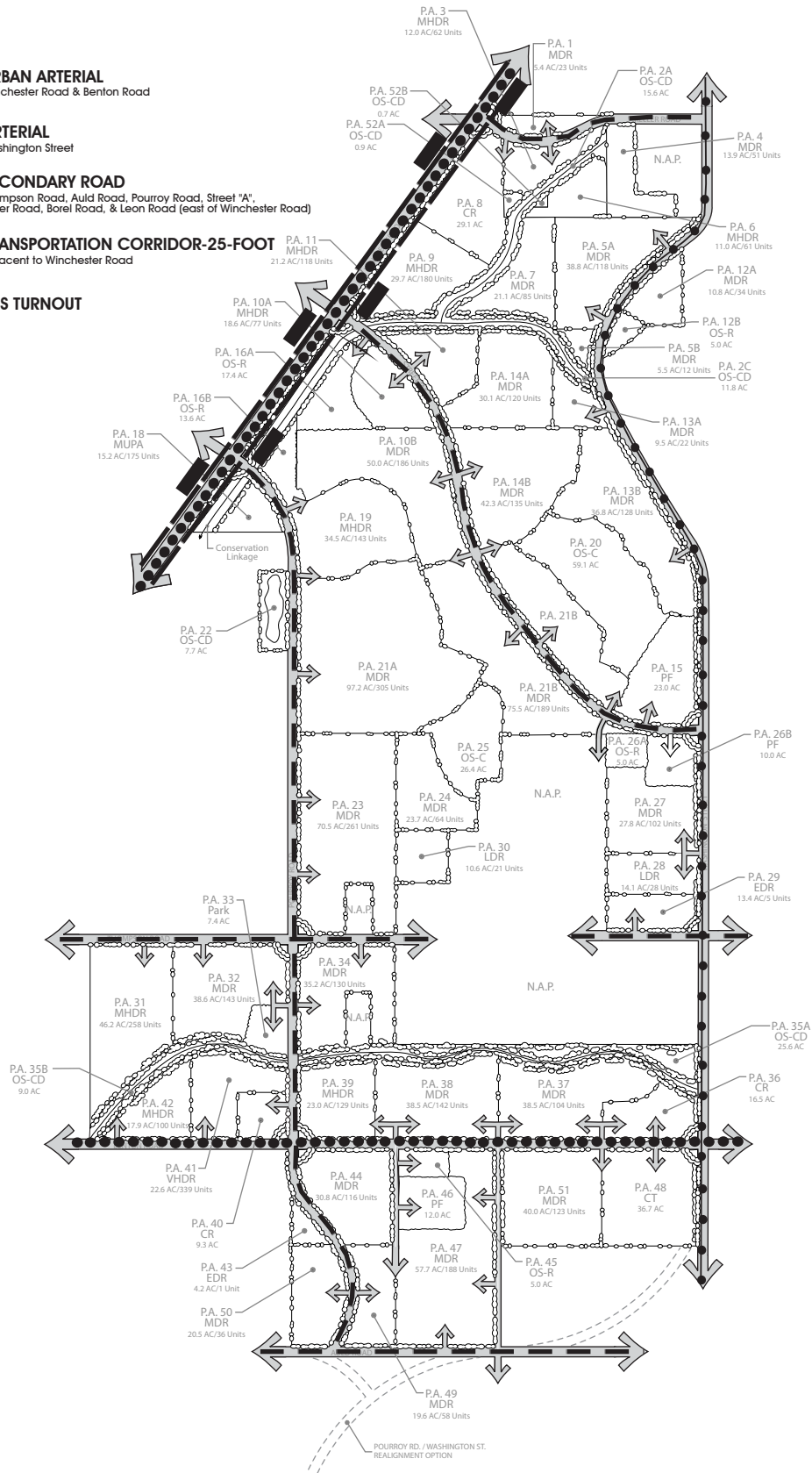

FIGURE III-2



Circulation Plan

WINCHESTER 1800

III. SPECIFIC PLAN

Specific Plan No. 286, Amendment No. 6