

18. PLANNING AREA II-8: NATURE PARK PLANNING AREA (SEE EXHIBITS III-73 AND III-74)

a. General Requirements

- (1) The 5.5-acre nature park is situated south of the drainage channel, is bounded by Clay Canyon Drive and Jameson Road. The nature park is located within the south portion of the overall Wild Rose Development site (see Exhibits III-9 and III-74).
- (2) The fault setback zone runs through the nature park area.
- (3) Access will be from Clay Canyon Drive (see Exhibit III-74).
- (4) Collector streetscape will buffer the nature park from Clay Canyon Drive (see Exhibits III-9 and III-16).
- (5) A fuel modification edge will also be provided through the park area (see Exhibit III-16).
- (6) This area is subject to the open space, landscaping, circulation and infrastructure design standards.
- (7) General mitigation measures are presented in Section II. The following measures specifically apply to this planning area:
 - (a) Designation of open space and community parks will help preserve the natural appearance of the area. Planning and architectural design treatments will be used to enhance the appearance of the site.
 - (b) The Specific Plan includes provisions for community park sites, a natural park and preservation of natural open space to help meet the demand for recreational opportunities.

b. Specific Development Requirements

- (1) Development of Planning Area II-8 shall conform to the requirements of Ordinance 348.2884b (see Part 3 of this document).

19. PLANNING AREA II-9: OPEN SPACE PRESERVE PLANNING AREA (SEE EXHIBIT III-75)

a. General Requirements

- (1) The 74.4-acre open space preserve is situated within the western portion of the overall Wild Rose Development site (see Exhibit III-75).
- (2) In addition to the construction of drainage facilities, a water storage tank will be constructed within the open space preserve (Exhibit III-8).
- (3) The fault setback zone runs through the open space preserve area.

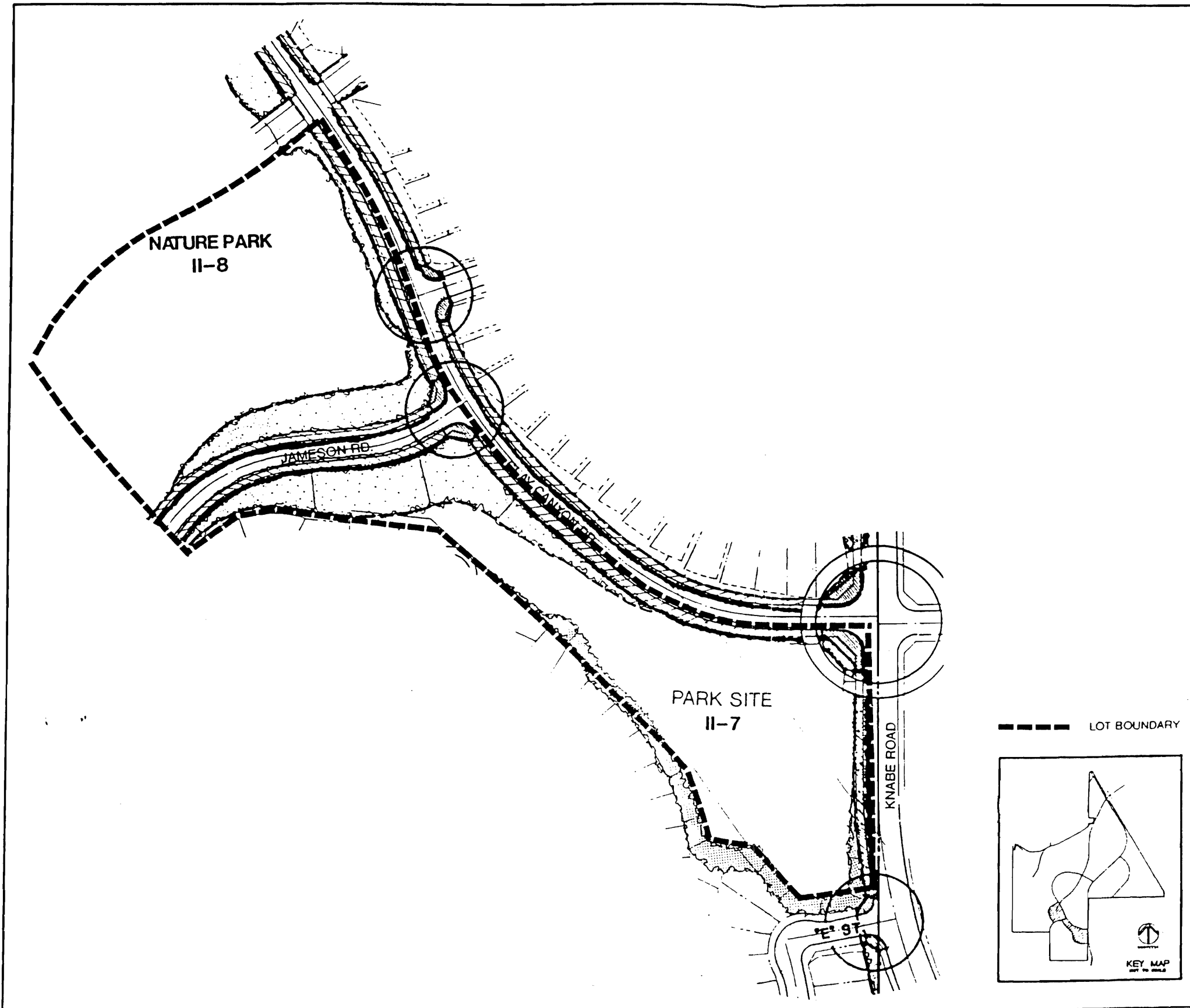

LEGEND

- PRIMARY ENTRY, PRIMARY INTERSECTION, SECONDARY INTERSECTION
- PALM TREES
WASHINGTONIA ROBUSTA
- FLOWERING ACCENT TREES
JACARANDA ACUTIFOLIA
KOELREUTERIA
TIJUANA TIPU
LAGERSTROEMIA NOICA
- EVERGREEN TREES
CUPANOPSIS ANACARDODES
PINUS MEXICENSIS
ERODIOLA DEFLIXA
JUNIPERUS CHINENSIS TORULOSA
EUCALYPTUS CITRIDODORA
- DECIDUOUS TREES
POPULUS NIGRA TALUCA
PRUNUS CERASIFERA
- EVERGREEN SHRUBS
AGAPANTHUS AFRICANUS
NERIUM OLEANDER
PITTIOSPORUM TOBIRA
XYLOSMA CONGESTUM 'COMPACTA'
TECOMARIA CAPENSIS
- GROUND COVER
TRAILING YELLOW GAZANAS
HEDERA HELIX MAHNS
- ROSES
- TURF
- STREETScape-KNABE ROAD
- STREET TREES
PLATANUS ACERFOJA
ALNUS RHOMBIFOLIA
LIQUIDAMBER STYRACFLUA
- EVERGREEN SHRUBS
AGAPANTHUS AFRICANUS
NERIUM OLEANDER
PITTIOSPORUM TOBIRA
XYLOSMA CONGESTUM 'COMPACTA'
RAPHIOLEPIS NOICA
TECOMARIA CAPENSIS
- GROUND COVER
TRAILING YELLOW GAZANIA
HEDERA HELIX MAHNS
O'CONNORS LEGUME
- VINES
PARTHENOCISSUS TRICUSPIDATA
- TURF
- STREETScape-COLLECTOR STREET
- STREET TREES
JACARANDA ACUTIFOLIA
KOELREUTERIA
TIJUANA TIPU
- EVERGREEN SHRUBS
GREVILLEA NOELII
HEMEROCALLIS
LANTANA MONTI EVIDENSIS
PHOTNIA FRASERI
TECOMARIA CAPENSIS
VIBURNUM JAPONICUM
- GROUND COVER
HEDERA HELIX MAHNS
TRAILING YELLOW GAZANIA
- VINES
PARTHENOCISSUS TRICUSPIDATA
- TURF
- SLOPE PLANTING
- TREE
EUCALYPTUS CITRIDODORA
PINUS MEXICENSIS
- EVERGREEN SHRUBS
SAME AS SHRUBS OF ADJACENT ROAD
- GROUND COVER
SAME AS GROUND COVERS OF ADJACENT ROAD

--- LOT BOUNDARY

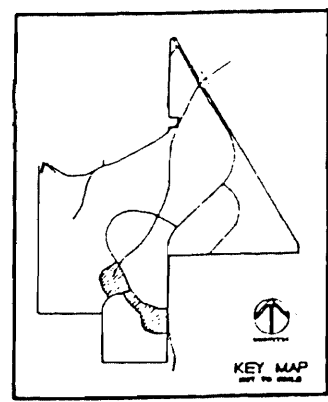

WILD ROSE

UDC HOMES

REVISED ON JUNE 27, '89
DATE JUNE 19, '88
NOT TO SCALE

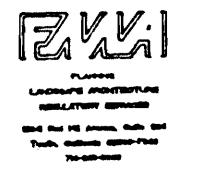

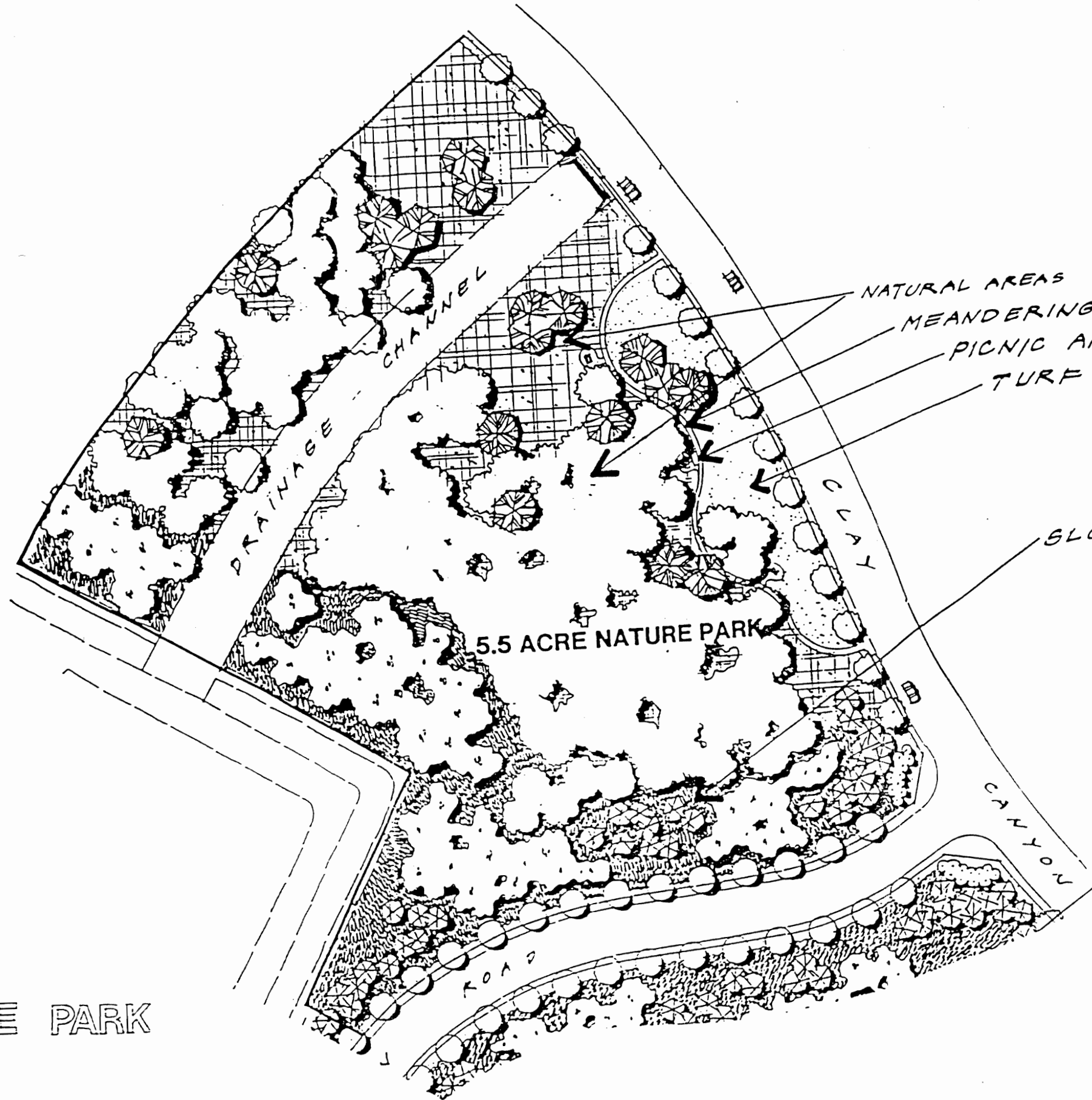

NATURAL AREAS TO REMAIN
 MEANDERING PATH
 PICNIC AREAS
 TURF

SLOPE AREAS

WILD ROSE
 CONCEPTUAL NATURE PARK
 UDC HOMES

EXHIBIT 74

JUNE 28, 1989
 N.T.S.



EKKI
 FLORIDA STATE BOARD OF PARKS AND RECREATION
 PLANNING
 LANDSCAPE ARCHITECTURE
 REGULATORY SERVICES
 15641 Red Oak Avenue, Suite 203
 Tuckahoe, Virginia 22091
 703-299-9377